

# RMIT OPEN DAY

---

---



# Event Guide

**11 AUG**

---

---

City & Brunswick  
campuses

**4 AUG**

---

---

Bundoora  
campus

Open the door to  
endless opportunities.

# Contents

What's on at Open Day?	4
Student life and support services at Open Day	5
How to read RMIT's building numbers	7
Questions to ask	8
Access and Inclusion	9
Join our Aviation Academy Open Days	10

<b>Bundoora campus</b>	<b>11</b>	<b>City campus</b>	<b>17</b>
General information	11	General information	17
Campus map	12-13	Campus map	18-19

---

## Biomedical Science 14

- Biomedical Sciences
- Laboratory Medicine
- Pharmaceutical Sciences

---

## Building 14

- Air-conditioning and Refrigeration
- Carpentry
- Electrical and Instrumentation
- Plumbing
- Surveying

---

## Education 14

- Education – Primary, Primary and Early Childhood, and Primary and Secondary
- Early Childhood Education (postgraduate programs)
- Teacher Education (pathways to)

---

## Health 15

- Physiotherapy
- Medical Imaging (Nuclear Medicine and Radiotherapy)
- Nursing (Registered and Enrolled)
- Osteopathy
- Pharmacy
- Psychology (clinic tour)

---

## Psychology 16

---

## Science 16

- Biosciences and Biotechnology
- Food Technology and Nutrition Science
- Science

---

## Architecture 13

- Architecture
- Building Design
- Interior Decoration and Design
- Interior Design
- Landscape Architecture
- Urban Design

---

## Art 21

- Arts Management
- Creative and Cultural Production
- Fine Art – Ceramics, Drawing, Gold and Silversmithing, Painting, Print, Sculpture
- Video and Sound
- Photography
- Photography and Digital Imaging
- Visual Art

---

## Biomedical Sciences 23

- Biomedical Sciences
- Laboratory Medicine
- Pharmaceutical Science

---

## Building 23

- Air-conditioning and Refrigeration
- Building and Construction
- Carpentry
- Construction Management
- Electrical and Instrumentation
- Plumbing
- Project Management
- Surveying

---

## Business 24

- Accounting
- Accounting and Bookkeeping
- Blockchain Enabled Business
- Business and Commerce
- Business and Technology
- Business Information Systems
- Commerce
- Economics
- Entrepreneurship

## Acknowledgement of Country

RMIT University acknowledges the people of the Woi wurrung and Boon wurrung language groups of the eastern Kulin Nations on whose unceded lands we conduct the business of the University. RMIT University respectfully acknowledges their Ancestors and Elders, past and present.

RMIT also acknowledges the Traditional Custodians and their Ancestors of the lands and waters across Australia where we conduct our business.

Artwork: *Luwaytini* by Mark Cleaver, a proud Palawa person and RMIT Master of Human Resource Management student.

- Finance
- Financial Planning
- Global Business
- Human Resource Management
- Leadership and Management (Sport)
- Logistics
- Logistics and Supply Chain
- Management and Change
- Marketing
- Marketing and Communications
- Mortgage Broking
- Project Management
- Social Impact
- Social Media Marketing
- Strategy and Innovation
- Supply Chain and Logistics
- Work-Integrated Learning
- Virtual Reality

---

**Communication 27**

- Creative Writing
- Journalism
- Media
- Professional Communication (Advertising)
- Professional Communication (Digital Communication)
- Professional Communication (Public Relations)
- Professional Writing and Editing
- Screen Writing

---

**Design 28**

- Animation
- Communication Design
- Digital Media
- Furniture Design
- Games Design
- Graphic Design
- Industrial Design
- Interior Decoration and Design
- Innovation and Technology
- Product Design

---

**Education 29**

- Access and Inclusion
- Education Support
- Teacher Education Preparation
- Tertiary Preparation
- Training and Assessment

---

**Engineering 30**

- Aerospace Engineering and Aviation
- Applied Technologies and Advanced Manufacturing
- Aviation
- Biomedical Engineering
- Chemical Engineering
- Civil Engineering
- Electrical Engineering
- Electronic and Computer Systems Engineering

- Electronics and Communications Engineering
- Engineering (Aeronautical)
- Engineering (Mechanical)
- Engineering Technology
- Environmental Engineering
- Manufacturing Engineering
- Mechanical Engineering
- Mechatronics
- Software Engineering
- Vocational Education Engineering
- Women in STEM

---

**Environment 32**

- Environment and Society
- Environmental Science
- Sustainability and Urban Planning
- Urban and Regional Planning

---

**Fashion 32**

- Fashion and Textiles Design
- Fashion
- Fashion Design

---

**Health 33**

- Allied Health Assistance
- Dental Assisting
- Dental Studies
- Dental Technology and Prosthetics
- Health Sciences
- Medical Radiations
- Myotherapy and Massage
- Nursing (Registered and Enrolled)
- Osteopathy
- Pharmacy

---

**Information Technology 34**

- Augmented and Mixed Reality Games
- Computer Science
- Computing Technologies
- Cyber Security
- Data Science
- Information Technology
- IT and Networking
- Software Engineering
- Vocational Education IT
- Women in IT
- Women in STEM

---

**Law 35**

- Criminal Justice
- Criminology and Justice
- Criminology and Psychology
- Law
- Legal and Dispute Studies
- Legal Practice and Conveyancing

---

**Media 36**

- Journalism
- Live Production and Technical Services
- Media

- Media and Communication
- Music (Sound Production)
- Music Industry
- Screen and Media

---

**Property 37**

- Property Development, Investment and Valuation

---

**Psychology 37**

---

**Science 38**

- Applied Science
- Biotechnology and Biosciences
- Chemistry
- Conservation and Ecosystem Management
- Environmental Science
- Food Technology and Nutrition Science
- Geospatial Science
- Maths and Statistics
- Physics
- Space Science
- Surveying
- Women in STEM

---

**Social and Community 39**

- Alcohol and Other Drugs
- Community Services
- Disability Support
- Individual Support
- International Studies
- International Studies – Languages
- Mental Health
- Sexual Violence, Recognising and Responding to
- Social Science
- Social Work
- Translating and Interpreting
- Youth Work

---

**Brunswick campus 41**

**General information 41**

**Campus map 42-43**

---

**Design 44**

- Graphic Design
- Product Design

---

**Fashion 44**

- Custom Made Footwear
- Fashion
- Fashion Design
- Fashion Enterprise
- Fashion Styling
- Textile Design
- Textile Design and Technology

---

**Campus free wifi 47**

**Register your attendance to WIN 48**





# What's on at Open Day?

From tours to presentations, here are the main types of events you can catch at RMIT's Open Day. Find your study area's event schedule in the following pages and get ready to open the door to endless possibilities!

## Tours

Our Open Day tours are split up into study areas. Join a tour to explore the facilities specific to your course and see where you'll be learning as an RMIT student.

## Info points

Our info points are your chance to speak directly to our academics and current students about your course.

## Presentations

Presentations can include information about courses, course structure and pathways, as well as topics currently trending in your favourite study area.

## Displays

Our displays include exhibits and demonstrations relevant to your course or study area. Displays can involve discovering student art in a gallery or watching lab demonstrations.

## Workshops

Our workshops are designed to be informative and interactive. Gain an understanding of key topics within your study area by engaging in group discussion with current students and teaching staff, and getting hands-on in RMIT's facilities.

## Activities

Our Open Day activities are your chance to get competitive or creative with a range of hands-on experiences. You could take part in an activity that gives you a glimpse of your future study or lets you test out your interest in a student club.

## Where to go when you arrive?

If you're arriving at Open Day and aren't sure where to go first, head straight to the Welcome Marquee. Here's where you'll find the Welcome Marquee at each of our campuses:

- City – On Bowen Street next to Building 1
- Bundoora – Library courtyard
- Brunswick – Campus courtyard



# Student life and support services at Open Day

Uni is about so much more than just going to class, and RMIT is home to a vibrant student culture and support services. Here's a taste of the study life and support service teams you can catch on Open Day.

## Access and Inclusion

📍 Meet us at our outdoor marquees on the City and Bundoora campuses

The Access and Inclusion team help students from diverse backgrounds overcome social and financial barriers, ensuring everyone can access study at RMIT.

Come say hello to our team at Open Day and learn how life at RMIT can offer equitable learning and access to university through SEAS, SNAP and more.

## Women\* in STEM

📍 Meet us in our hub on the City campus (Building 10, Level 4, Room 51)

Women\* in STEM connects with and provides opportunities for our women and non-binary students to connect, grow and flourish in the field of STEM.

Visit the hub to meet our Women\* in STEM ambassadors, try a STEM-based activity, ask questions of the team and attend our Q&A panel sessions at the City campus – check the schedule for exact times.

## Industry and global experiences

📍 Meet us at our marquees at all of our campuses, and at the Job Shop on the City campus (Building 10, Level 4, Room 71)

RMIT offers industry and global experiences to suit every student, whether you want to study overseas or get real-world experience from your industry of choice. We can help you find unique job opportunities, build your employability skills, network with industry professionals, and experience the world.

Come by our marquees, which you'll find at each of our campuses on the day. You'll also find us at the Job Shop on the City campus.

## Ngarara Willim Centre

📍 Meet us on the City campus (Building 5, Level 1, Room 5)

The Ngarara Willim Centre is a place for Aboriginal and Torres Strait Islander students to access pastoral, academic and cultural support.

Come past the Centre on Open Day to see a live broadcast by local Indigenous radio station 3KND, join a meet and greet with staff and enjoy a complimentary lunch inside!

## RMITV

📍 Meet us at our outdoor marquee on Bowen Street at the City campus

RMITV is RMIT's student-run television production house. It produces content for online platforms and Channel 31, a free-to-air community television channel.

We'll be on Bowen Street at the City campus on Open Day if you'd like to chat with the students who make the magic happen.

## RMIT Skills and Jobs Centre

📍 Meet us at our info points on the City and Bundoora campuses

Delivered in partnership with the Victorian Department of Education and Training, the RMIT Skills and Jobs Centre offers free, tailored career counselling for prospective students, job seekers and members of the community. At RMIT, we specialise in providing career services to vocational education students.

If you're looking for job insights and career advice, drop by our info points or come along to one of our presentations or workshops at the City and Bundoora campuses on Open Day.

## RMIT Library

📍 Meet us on the City campus (Building 10-12, Level 5)

The University Library offers access to study support services and physical and digital collections that give students the resources to accomplish their goals. It's not just a place for research, it also nurtures creativity and invention with facilities such as Makerspace.

Experience our library first-hand by exploring the facilities and speaking to library staff on the day.





### **RMIT Training**

📍 **Meet us at our outdoor marquee on the City campus**

RMIT Training deliver courses to international students to prepare them for study in Australia.

Find us at our marquee on Bowen Street at the City campus, where you can learn more about Foundation Studies and English for Academic Purposes pathway courses that can provide a direct pathway into an RMIT course.

### **Student clubs and societies**

📍 **Meet clubs at their marquees at all campuses**

There's something for everyone. You're guaranteed to find a club that will appeal to your passions and interests.

Many of our clubs and societies will be present at Open Day. Explore what's on offer by visiting each of their marquees to chat to their current members and find out more about them.

### **Sports and fitness**

📍 **Meet us at the Bundoora campus at the indoor courts (Building 203)**

Discover our gyms, fitness facilities, learn about our social sports and clubs, as well as how you can get active at RMIT.

We'll be running activities at the indoor courts (Building 203 on the Bundoora campus where you can check out everything from volleyball to badminton.

### **Study@RMIT**

📍 **Meet us as the General Information marquee across our campuses**

The Study@RMIT team can help answer your course or application questions and provide general information about pathways, important dates and timetable advice.

Our team will be available at the City campus Open Day for sit down one-on-one conversations and application support. See the team at the General Information marquee for more details.

### **Multifaith Chaplaincy and Wellbeing Centre**

📍 **Meet us on the City campus (Building 47)**

Multifaith Chaplaincy provides support to students and staff of all faiths and also offers guidance to those who are non-religious. Everyone is welcome to come and have a chat with a chaplain, even if you don't identify as religious.

Join us for meditation or a prayer in Building 47 on the City campus.

### **RMIT Vietnam**

📍 **Meet us at our outdoor marquee at the City campus**

The RMIT Vietnam Global Experience team will be at Open Day chatting to students about exchange study opportunities at RMIT's Vietnam campuses. The team welcomes you to come by and learn more about what an exchange study experience could look like for you.

In addition to answering all your questions, team members will also be running interactive games at the booth to showcase the exciting cultural and study experiences in Vietnam.





# How to read RMIT's building numbers

**Need help finding an RMIT building? Just search for the building number on Google Maps!**

Once you reach the building you're looking for, check this event schedule to see what level and room your activity is being hosted in. You'll notice signs within the building that look like number codes. These will get you to your level and room, so here's how to decode them like a true RMIT student!

## 80.5.002

Building no.      Level      Room number

### International students

📍 **Meet us at our outdoor marquee at the City campus and General Information marquees at Brunswick and Bundoora**

The International team is made up of multilingual experts who can help answer any questions you have about getting started and settling into study at RMIT as an international student. Chat to them about everything from study options to visa requirements and receive on-the-spot application assistance.

You'll find team members at each of our Open Day events. They'll be in the same courtyard/lawn as the Welcome marquees at each campus.

### RMIT Culture

📍 **Meet us at our galleries on the day (see below for more details)**

RMIT Culture oversees the University's cultural spaces, creative programs and collections. This is the team responsible for bringing many creative opportunities to life at RMIT, including exhibitions, film screenings and more.

Visit Culture at two galleries on Open Day: 'Future folds: contemporary investigations in origami' at Design Hub Gallery in

Building 100 where you can join a folding workshop, and meet Vietnamese artist Võ Thanh Tiến at 'đây đó (here/there)' in the First Site Gallery, Building 16.

### Postgraduate information

📍 **Meet us at our outdoor marquee on the City campus lawn**

Learn all there is to know about RMIT's postgraduate study options, including entry requirements, credits, tuition fees, course structures, timetables and more.

Come and meet the team, enjoy a free one-on-one careers consultation and receive instant application support.

### Language electives: your passport to the world

📍 **Meet us at the City campus (Building 80, Level 3, Room 3)**

Enhance your undergraduate or postgraduate degree with a language elective. Whether you're interested in travel or an international career, choose from Chinese, French, German, Italian, Japanese or Spanish. From beginner to advanced levels, learn to speak like a local. Check your course structure to see how many electives you can choose.

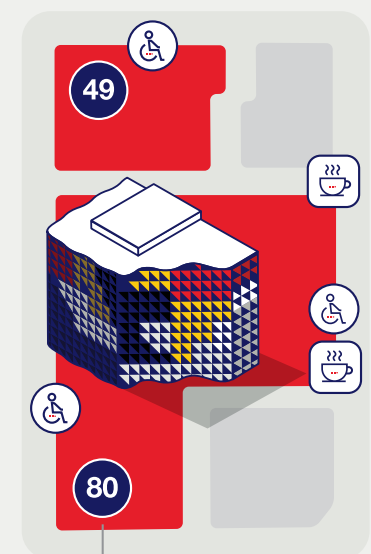

Building number



# Questions to ask

At Open Day, you'll get the opportunity to chat to the Study@RMIT team, your future teachers, current students and more. Here are some questions you might like to ask each group, and where to find them.



## Study@RMIT

📍 Find us at the **General Information Marquee**

- What are the entry requirements and subject prerequisites for my course?
- What kind of study and employability support does RMIT offer?
- What are my options if I don't get the ATAR I need for my course?
- Does my course have any selection tasks that I need to complete?



## Academics

📍 Find us at **info points, displays, workshops and activities**

- How does my course help me gain practical experience?
- Will I get to work with future employers in my course?
- What sort of career can my course lead to?
- Are there opportunities to study overseas?



## Current students

📍 Find us at **info points, displays, workshops and activities**

- Why did you choose RMIT?
- What has your experience at RMIT been like?
- What helped you make the transition from school to uni?



## Student life

📍 Find us at **info points**

- How do RMIT students get involved with clubs and societies?
- What social and cultural events are available at RMIT?
- Are there any ways to help students find their crowd and discover new interests?





# Access and Inclusion



## Auslan interpreters available

Auslan interpreters will be on hand at all three campuses for visitors with hearing impairments.

Find them at:

### **Bundoora campus**

Access and Inclusion Marquee in the Library Courtyard

### **City campus**

Access and Inclusion Marquee on Bowen Street

### **Brunswick campus**

General Information Marquee in the courtyard outside Building 514



## Supporting visitors living with disability

Our Equitable Learning team and support personnel will be available at both the Bundoora and City campuses.

The City campus will offer both an outdoor marquee as well as a quiet indoor space where visitors can have one-on-one conversations with the team to learn more about how we can support their journey as a student at RMIT.

Plus, we'll have merchandise giveaways!

### **Bundoora campus**

Access and Inclusion Marquee in the Library Courtyard

### **City campus outdoor**

Access and Inclusion Marquee on Bowen Street

### **City campus indoor**

Access and Inclusion Hub at Building 8, Level 4, Room 011



## Sensory-sensitive rooms available (City campus)

This year, we are offering sensory-sensitive spaces at the City campus for neurodiverse visitors or anyone needing a break from the bustle of a busy event. Find these calm spaces at:

### **Building 12, Level 5, Room 104**

### **Building 80, Level 3, Room 013**



10

# Join our Aviation Academy Open Days

Discover your study opportunities at our Point Cook and Bendigo flight training facilities. Take a tour of our facilities and fleet of aircraft, meet our flight instructors and students, hop in a flight simulator, join an information session and learn how RMIT will help you launch a career in aviation and flight training.

## Point Cook

Sunday 18 August,  
10.00am – 4.00pm

RAAF Base Point Cook,  
Point Cook Road,  
Point Cook VIC

**Note:** Australian issued photo ID or passport will be required to access the RAAF Base.

## Bendigo

Sunday 25 August,  
10.00am – 3.00pm

RMIT Bendigo Airfield,  
35 Victa Road,  
East Bendigo VIC



Register today

For any queries, please get in touch with the RMIT STEM College at [stemevents@rmit.edu.au](mailto:stemevents@rmit.edu.au)





# Bundoora campus

Sunday 4 August, 10am–4pm

## General information

	Location	Activities	Time	Duration	Study level
Career and job support	<a href="#">Building 202 Level 2 Room 8</a>	Presentation	2.00pm	30 mins	All levels of study
Introduction to RMIT and Early Offer	<a href="#">Building 224 Level 1 Room 2</a>	Presentation	11.00am	60 mins	All levels of study
Moving to Melbourne – regional and interstate students	<a href="#">Building 207 Level 2 Room 2</a>	Presentation	1.00pm	30 mins	All levels of study
Parent information session	<a href="#">Building 207 Level 2 Room 2</a>	Presentation	12.00pm	30 mins	All levels of study
Resume writing	<a href="#">Building 202 Level 2 Room 8</a>	Workshop	2.30pm	90 mins	All levels of study

Click on building location to open Google Maps

## Pathway to Health: An exciting journey into healthcare

Join us to explore the cutting-edge technology in ultrasound equipment, delve into STEM topics, and discover the vital functions of health disciplines. Learn about rewarding careers in health and wellbeing, radiation and nursing. Don't miss this exciting opportunity to immerse yourself in the future of healthcare.

### KEY:

**Info point** Drop-in, drop-out areas where you can speak to us about your course at any time.

**Presentation** Hear from our academics on hot topics in your study area or get an overview of your course.

**Tour** Join a study area tour to discover the facilities your course will be taught in!

**Display** Exhibits and demonstrations relevant to your course or study area.

**Activity** Practical tasks and experiences suitable for all skill levels.

**Workshop** Informative and interactive discussions with current students and academics.

# Bundoora campus

Sunday 4 August

## Transport and Services

## General Info Points

- Building for Open Day
- Other Building
- Sports Facilities
- 123 Building Number
- Road
- Parklands

- + First Aid
- P Parking
- ♿ Ramp
- ! Emergency Assembly Area
- S Security
- Food Trucks
- Tram Stop
- Bus Stop

- I General Information
- I Welcome Marquee
- I Student Clubs
- S STEM Hub
- S STEM Immersive Experience
- I Access and Inclusion, Skills and Jobs Centre
- I Student Accommodation Providers
- I Global Experiences and Careers
- 🎁 Prize Hub

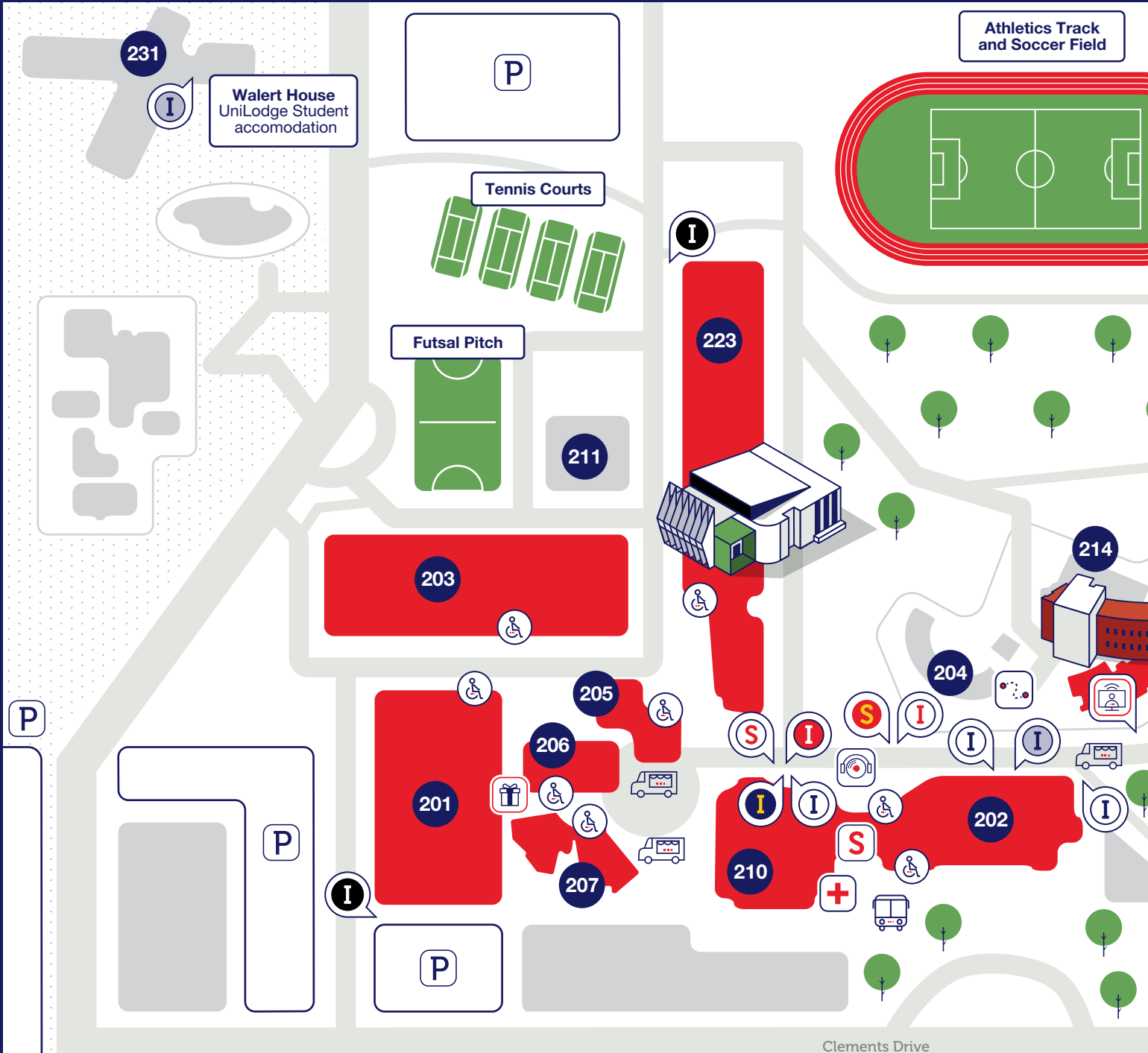





To find out the times and locations of events happening around campus, scan the QR code to view the full schedule.

### Other



Education

203

Sports Centre



Health Sciences

210

Library



RMIT Trades, Vocational Education Surveying



Entertainment Precinct



### Keelbundoora Scarred Trees and Heritage Trail

Walk the Keelbundoora Scarred Trees and Heritage Trail and learn about the Wurundjeri people and their history. Start at Building 202 and follow the totem poles.



### Transport and access

Tram route 86 runs from Melbourne City (Docklands) to the Bundoora East campus (stop 71).

The Bundoora campus lies between Thomastown Station (South Morang Line) and Greensborough Station (Eltham Line).

Bus services run from each of these stations to the campus.

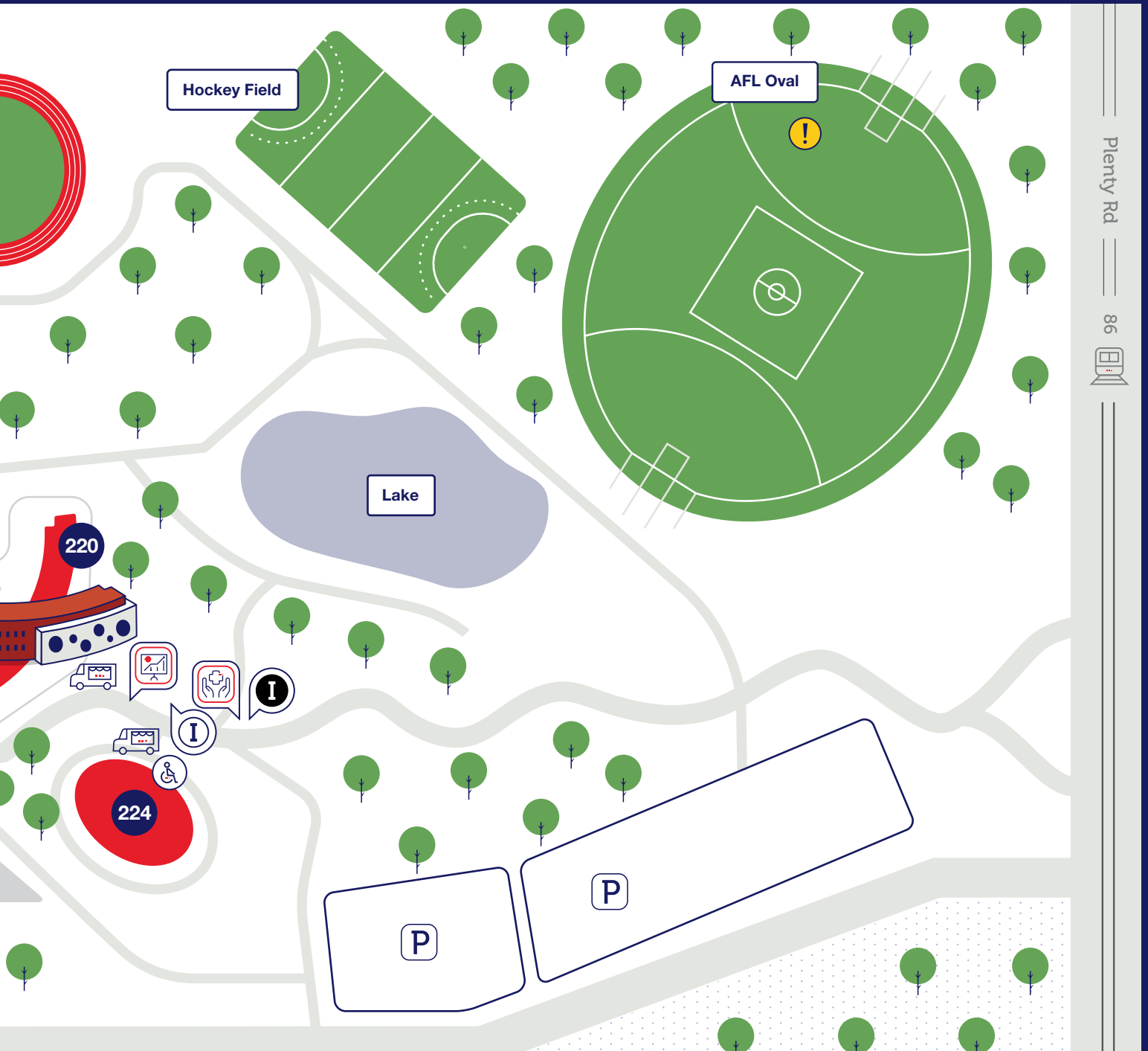

For more information visit  
[rmit.edu.au/biomedical-sciences](http://rmit.edu.au/biomedical-sciences)

## Biomedical Science

	Location	Activities	Time	Duration	Study level
Biomedical Sciences	<a href="#">Building 201</a> <a href="#">Level 2 Room 21</a>	Info point	10.00am	All day	Bachelor
	<a href="#">Building 207</a> <a href="#">Level 3 Room 2</a>	Presentation	10.15am, 12.15pm	30 mins	Bachelor
Laboratory Medicine	<a href="#">Building 201</a> <a href="#">Level 2 Room 21</a>	Info point	10.00am	All day	Bachelor
	<a href="#">Building 207</a> <a href="#">Level 3 Room 2</a>	Presentation	11.30am, 1.30pm	30 mins	Bachelor
Laboratory Medicine Haematology Lab Tour	<a href="#">Building 223</a> <a href="#">Level 2 Room 24</a>	Tour	10.00am	All day	Bachelor
Laboratory Medicine Pathology Museum	<a href="#">Building 201</a> <a href="#">Level 10, Room 5</a>	Tour	10.00am	All day	Bachelor
Pharmaceutical Sciences	<a href="#">Building 205</a> <a href="#">Level 2 Room 15</a>	Info point	10.00am	All day	Bachelor
	<a href="#">Building 207</a> <a href="#">Level 2 Room 1</a>	Presentation	10.15am, 12.15pm	30 mins	Bachelor

For more information visit  
[rmit.edu.au/building](http://rmit.edu.au/building)

## Building

	Location	Activities	Time	Duration	Study level
Air-conditioning and Refrigeration	The Spine	Info point	10.00am	All day	Apprenticeship
Carpentry	The Spine	Info point	10.00am	All day	Apprenticeship
Electrical and Instrumentation	The Spine	Info point	10.00am	All day	Apprenticeship
Plumbing	The Spine	Info point	10.00am	All day	Apprenticeship
Surveying	The Spine	Info point	10.00am	All day	Diploma/Certificate

For more information visit  
[rmit.edu.au/education](http://rmit.edu.au/education)

## Education

	Location	Activities	Time	Duration	Study level
Bachelor of Education <ul style="list-style-type: none"> <li>■ Primary</li> <li>■ Primary and Early Childhood</li> <li>■ Primary and Secondary</li> </ul>	<a href="#">Building 220</a> <a href="#">Level 2 Room 2</a>	Info point	10.00am	All day	Bachelor
	<a href="#">Building 220</a> <a href="#">Level 2 Room 3</a>	Presentation	10.00am, 11.30am, 1.00pm, 2.30pm	30 mins	Bachelor
Postgraduate Programs in Early Childhood Education	<a href="#">Building 220</a> <a href="#">Level 2 Room 5</a>	Info point	10.00am	All day	Postgraduate
Pathways to Teacher Education	<a href="#">Building 220</a> <a href="#">Level 2 Room 2</a>	Info point	10.00am	All day	Certificate/Diploma
	<a href="#">Building 220</a> <a href="#">Level 2 Room 3</a>	Presentation	10.00am, 11.30am, 1.00pm, 2.30pm	30 mins	Certificate/Diploma

**KEY:****Info point** Drop-in, drop-out areas where you can speak to us about your course at any time.**Presentation** Hear from our academics on hot topics in your study area or get an overview of your course.**Tour** Join a study area tour to discover the facilities your course will be taught in.**Display** Exhibits and demonstrations relevant to your course or study area.**Activity** Practical tasks and experiences suitable for all skill levels.**Workshop** Informative and interactive discussions with current students and academics.



# Health



For more information visit  
[rmit.edu.au/health](http://rmit.edu.au/health)

	Location	Activities	Time	Duration	Study level
Careers in Physiotherapy	<a href="#">Building 201 Level 2 Room 22</a>	Info point	10.00am	All day	Master
	<a href="#">Building 207 Level 3 Room 2</a>	Presentation	10.45am, 12.45pm	30 mins	Master
	<a href="#">Building 203 Level 2 Room 10 and 10A</a>	Display	10:00am	All day	Master
Medical Imaging	<a href="#">Building 201 Level 2 Room 21</a>	Info point	10.00am	All day	Bachelor
	<a href="#">Building 207 Level 2 Room 6</a>	Presentation	10.15am, 11.45am, 1.15pm	30mins	Bachelor
Medical Imaging – Nuclear Medicine Lab Tour	<a href="#">Building 201 Level 8 Room 4</a>	Tour	10.00am	All day	Bachelor
Medical Imaging – Radiotherapy Simulation	<a href="#">Building 201 Level 8 Room 3</a>	Activity	10.00am	All day	Bachelor
	<a href="#">Building 201 Level 8 Room 6</a>	Activity	10.00am	All day	Bachelor
Nursing (Registered Nurse)	<a href="#">Building 201 Level 3 Foyer</a>	Info point	10.00am	All day	Bachelor
	<a href="#">Building 207 Level 3 Room 3</a>	Presentation	10.30am, 12.00pm, 1.30pm	30 mins	Bachelor
Nursing (Enrolled Nurse)	<a href="#">Building 201 Level 3 Foyer</a>	Info point	10.00am	All day	Diploma
	<a href="#">Building 207 Level 3 Room 3</a>	Presentation	11.00am, 12.30pm, 2.00pm	30 mins	Diploma
	<a href="#">Building 201 Level 3 Room 8</a>	Tour	10.00am	All day	Bachelor
Osteopathy	<a href="#">Building 201 Level 2 Room 22</a>	Info point	10.00am	All day	Bachelor
	<a href="#">Building 207 Level 2 Room 6</a>	Presentation	11.00am, 12.30pm	30 mins	Bachelor
Pharmacy	<a href="#">Building 205 Level 2 Room 11</a>	Info point	10.00am	All day	Bachelor
	<a href="#">Building 207 Level 2 Room 1</a>	Presentation	10.45am, 12.45pm	30 mins	Bachelor
RMIT Clinic: Physiotherapy, Osteopathy and Psychology	<a href="#">Building 203 Level 2, Room 11</a>	Tour	10.00am	All day	Bachelor
Sports Academy	<a href="#">Building 203 Level 2 Room 1</a>	Display	10.00am	All day	

**Click on building location to open Google Maps**

## KEY:

**Info point** Drop-in, drop-out areas where you can speak to us about your course at any time.

**Presentation** Hear from our academics on hot topics in your study area or get an overview of your course.

**Tour** Join a study area tour to discover the facilities your course will be taught in.

**Display** Exhibits and demonstrations relevant to your course or study area.

**Activity** Practical tasks and experiences suitable for all skill levels.

**Workshop** Informative and interactive discussions with current students and academics.

# Psychology



For more information visit  
[rmit.edu.au/psychology](http://rmit.edu.au/psychology)

	Location	Activities	Time	Duration	Study level
Psychology	<a href="#">Building 201 Level 2 Room 22</a>	Info point	10.00am	All day	Bachelor
	<a href="#">Building 207 Level 2 Room 1</a>	Presentation	11.30am, 1.30pm	30 mins	Bachelor/Honours/ Master

# Science



For more information visit  
[rmit.edu.au/science](http://rmit.edu.au/science)

	Location	Activities	Time	Duration	Study level
Biosciences and Biotechnology	<a href="#">Building 201 Level 2 Room 21</a>	Info point	10.00am	All day	Bachelor
	Central Courtyard	Info point	10.00am	All day	Bachelor
Food Technology and Nutrition Science	<a href="#">Building 207 Level 2 Room 4</a>	Presentation	10.30am, 1.00pm	30 mins	Bachelor
	<a href="#">Building 201 Level 5 Room 1</a>	Tour	10.00am	All day	Bachelor
Food Technology: VR experience inside the human body	Central Courtyard	Activity	10.00am	All day	Bachelor
Science	<a href="#">Building 201 Level 2 Room 22</a>	Info point	10.00am	All day	Bachelor

Click on building location to open Google Maps

## Pathway to Health: An exciting journey into healthcare

Join us to explore the cutting-edge technology in ultrasound equipment, delve into STEM topics, and discover the vital functions of health disciplines. Learn about rewarding careers in health and wellbeing, radiation and nursing. Don't miss this exciting opportunity to immerse yourself in the future of healthcare.

### KEY:

**Info point** Drop-in, drop-out areas where you can speak to us about your course at any time.

**Presentation** Hear from our academics on hot topics in your study area or get an overview of your course.

**Tour** Join a study area tour to discover the facilities your course will be taught in.

**Display** Exhibits and demonstrations relevant to your course or study area.

**Activity** Practical tasks and experiences suitable for all skill levels.

**Workshop** Informative and interactive discussions with current students and academics.



# City campus

Sunday 11 August, 10am–4pm

## General information

	Location	Activities	Time	Duration	Study level
Career and Job Support	<a href="#">Building 78</a> <a href="#">Level 1 Room 1</a>	Presentation	11.00am, 2.30pm	30 mins	All levels of study
Choosing your Career and Program	<a href="#">Building 10</a> <a href="#">Level 4 Room 70</a>	Presentation	11.00am, 1.00pm	30 mins	All levels of study
Early Offer Program	<a href="#">Building 8</a> <a href="#">Level 4 Room 13</a>	Presentation	2.00pm	30 mins	All levels of study
Global experiences – info session	<a href="#">Building 10</a> <a href="#">Level 4 Room 70</a>	Presentation	10.00am, 12.00pm, 2.00pm	30 mins	All levels of study
International Student FAQ Check	<a href="#">Building 8</a> <a href="#">Level 4 Room 13</a>	Presentation	1.00pm	30 mins	All levels of study
Introduction to RMIT	<a href="#">Building 80</a> <a href="#">Level 4 Room 11</a>	Presentation	10.30am, 1.00pm, 2.30pm	30 mins	All levels of study
Job Shop	<a href="#">Building 10</a> <a href="#">Level 4 Room 71</a>	Info point	10.00am	All day	All levels of study
Learn a language (Chinese, French, Japanese and Spanish)	<a href="#">Building 8</a> <a href="#">Level 3 Room 3</a>	Info point	10.00am	All day	All levels of study
Moving to Melbourne – regional and interstate students	<a href="#">Building 8</a> <a href="#">Level 4 Room 13</a>	Presentation	1.30pm	30 mins	All levels of study
Ngarara Willim Centre Indigenous Student Support	<a href="#">Building 5</a> <a href="#">Level 1 Room 1</a>	Display	10.00am	All day	All levels of study
Parent information session	<a href="#">Building 8</a> <a href="#">Level 4 Room 13</a>	Presentation	12.30pm	30 mins	All levels of study
Pathways information	<a href="#">Building 8</a> <a href="#">Level 4 Room 13</a>	Presentation	11.30am	60 mins	All levels of study
Skills and Job Centre	<a href="#">Building 78</a> <a href="#">Level 1 Room 1</a>	Info point	10.00am	All day	All levels of study
The Library	<a href="#">Building 10</a> <a href="#">Level 5 Library</a>	Info point Display	10.00am	All day	All levels of study
Work-integrated learning in communication, design and media	<a href="#">Building 14 Level 2</a> <a href="#">Room 131</a>	Info point	10.00am	All day	All levels of study

### KEY:

**Info point** Drop-in, drop-out areas where you can speak to us about your course at any time.

**Presentation** Hear from our academics on hot topics in your study area or get an overview of your course.

**Tour** Join a study area tour to discover the facilities your course will be taught in.







**Display** Exhibits and demonstrations relevant to your course or study area.

**Activity** Practical tasks and experiences suitable for all skill levels.

**Workshop** Informative and interactive discussions with current students and academics.

# City campus

Sunday 11 August

-  Building for Open Day
-  Other Building
-  Building Number
-  Road
-  Metro Rail Tunnel
-  Pedestrian Access

## Transport and Services

-  Water and Coffee Stand
-  Tram Stop
-  First Aid
-  Bus Stop—free bus to Brunswick campus
-  Emergency Assembly Area
-  Ramp

## General Info Points

-  Welcome Marquee
-  General Information
-  International Students Info and Postgrad Studies
-  Student Accommodation Providers
-  Access and Inclusion
-  Ngarara Willim Centre
-  Student Clubs
-  Industry and Global Experiences
-  RMIT Vietnam, VTAC
-  RMIT Training
-  Esports
-  Prize Hub
-  Discover Engineering
-  Computing and Science Immersive Hub
-  Education
-  Women in STEM
-  Sensory Room
-  Entertainment Precinct



To find out the times and locations of events happening around campus, scan the QR code to view the full schedule.

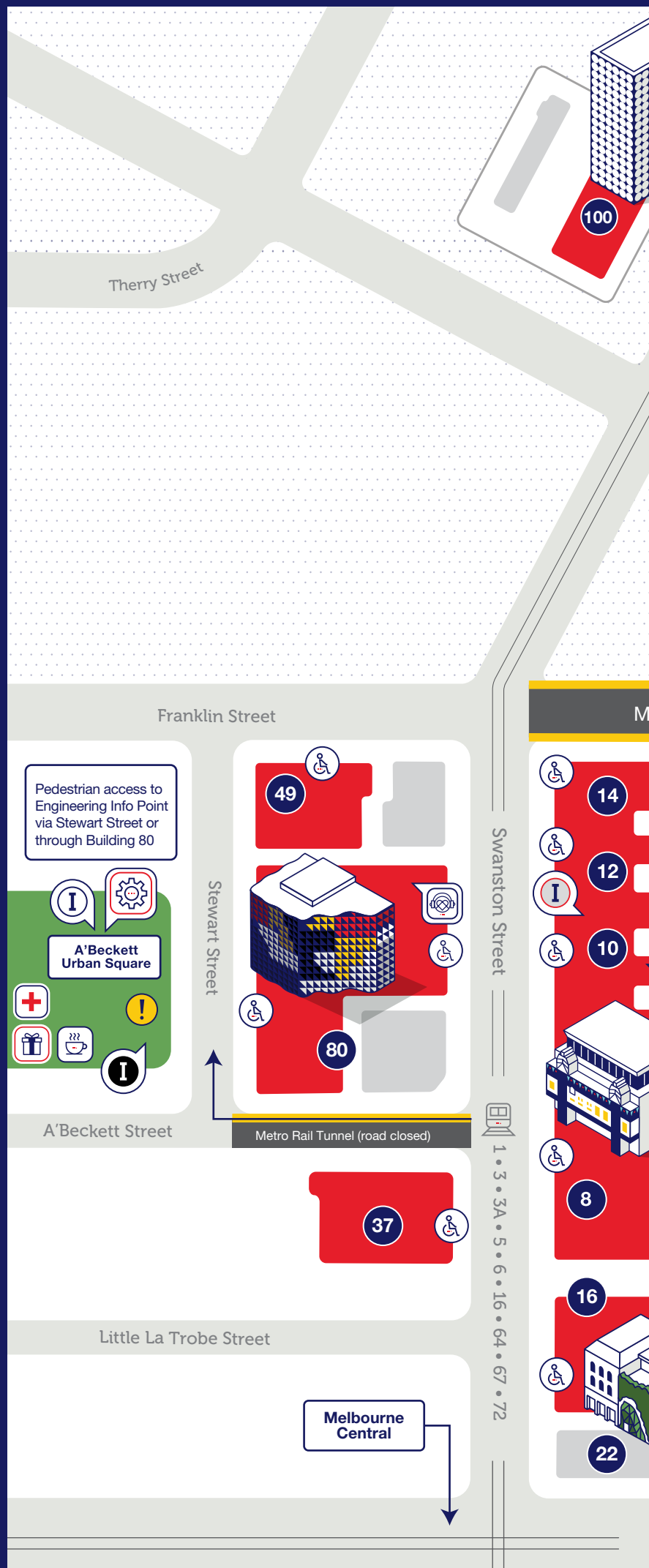



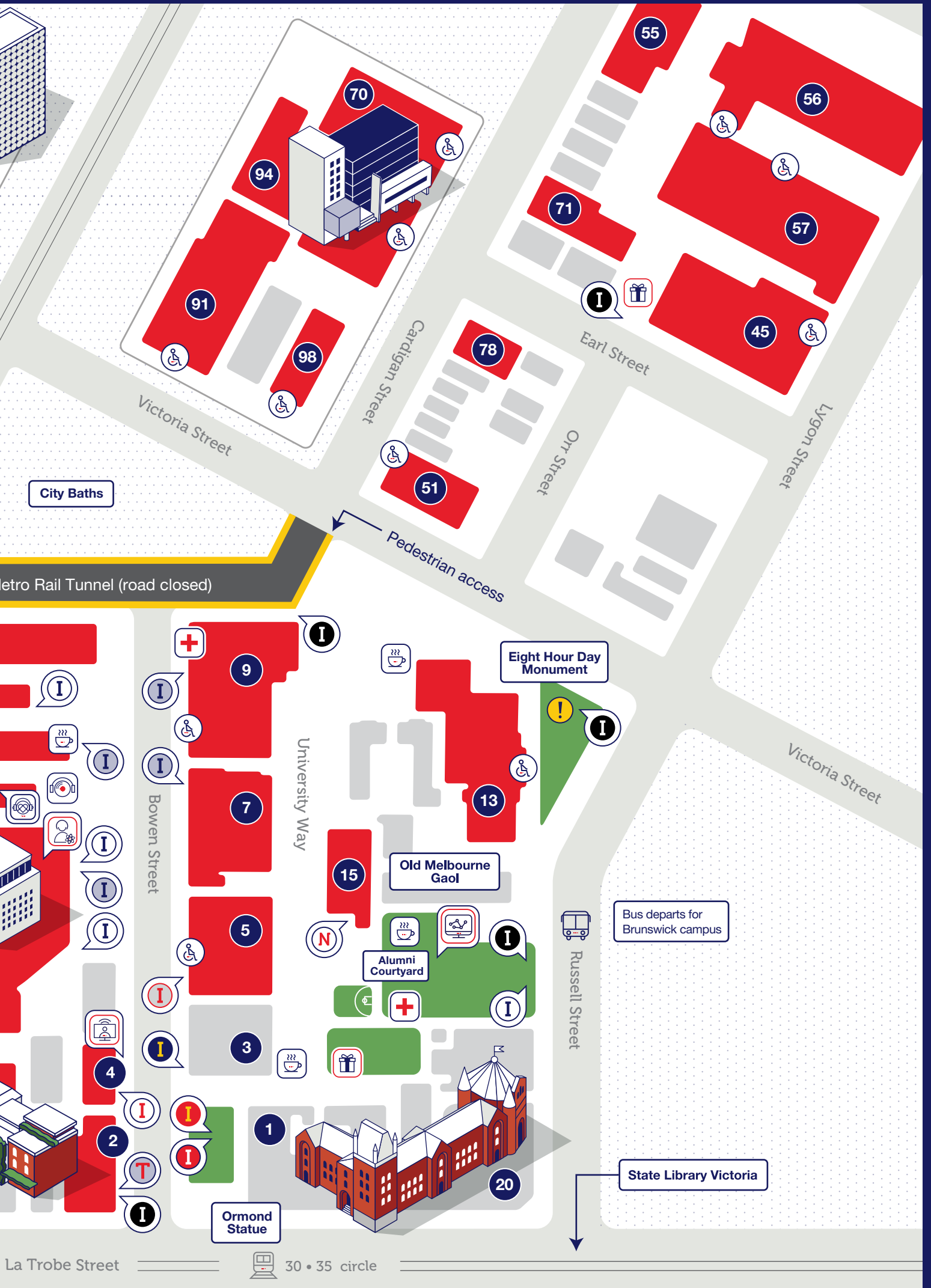

City Baths

Metro Rail Tunnel (road closed)

Cardigan Street

Earl Street

Orr Street

Lygon Street

Pedestrian access

Eight Hour Day Monument

University Way

Bouvern Street

Old Melbourne Gaol

Alumni Courtyard

Russell Street

Bus departs for Brunswick campus

State Library Victoria

Ormond Statue

La Trobe Street



30 • 35 circle

For more information visit  
[rmit.edu.au/architecture](http://rmit.edu.au/architecture)

# Architecture

	Location	Activities	Time	Duration	Study level
Architecture	<a href="#">Building 100 Level 5 Room 1</a>	<b>Info point</b> Display	10.00am	All day	Bachelor/Master
	<a href="#">Building 80 Level 2 Room 7</a>	<b>Presentation</b>	10.45am, 12.15pm, 1.45pm, 3.15pm	30 mins	Bachelor/Master
Building Design (Architectural)	<a href="#">Building 94 Level 5 Rooms 13 and 14</a>	<b>Info point</b>	10.00am	All day	Advanced Diploma
	<a href="#">Building 94 Level 1 Room 6</a>	<b>Presentation</b>	10.15am, 1.00pm	30 mins	Advanced Diploma
Interior Decoration and Design	<a href="#">Building 94 Level 2 Room 44</a>	<b>Info point</b>	10.00am	All day	Certificate/Diploma/ Associate Degree
	<a href="#">Building 94 Level 1 Room 6</a>	<b>Presentation</b>	11.35am	40 mins	Certificate/Diploma
	<a href="#">Building 94 Level 1 Room 6</a>	<b>Presentation</b>	1.30pm	30 mins	Certificate/Diploma
Interior Design	<a href="#">Building 94 Level 1 Room 6</a>	<b>Presentation</b>	12.15pm 2.00pm	30 mins	Associate Degree
	<a href="#">Building 100 Level 4 Room 1</a>	<b>Info point</b> Display	10.00am	All day	Bachelor/Honours/ Master
	<a href="#">Building 100 Level 3 Room 1</a>	<b>Presentation</b>	10.15am, 11.45am, 2.15pm	30 mins	Bachelor/Honours/ Master
Landscape Architecture	<a href="#">Building 100 Level 4 Room 4</a>	<b>Workshop</b>	11.00am, 12.30pm, 3.00pm	30 mins	Bachelor/Honours/ Master
	<a href="#">Building 100 Level 4 Room 1</a>	<b>Info point</b> Display	10.00am	All day	Bachelor/Master
	<a href="#">Building 100 Level 3 Room 1</a>	<b>Presentation</b>	11.00am, 12.30pm, 3.00pm	30 mins	Bachelor/Master
School of Architecture and Urban Design	<a href="#">Building 100 Level 3 Room 201</a>	Display	10.00am	All day	Bachelor/Honours/ Master

**Click on building location to open Google Maps****KEY:****Info point** Drop-in, drop-out areas where you can speak to us about your course at any time.**Presentation** Hear from our academics on hot topics in your study area or get an overview of your course.**Tour** Join a study area tour to discover the facilities your course will be taught in.**Display** Exhibits and demonstrations relevant to your course or study area.**Activity** Practical tasks and experiences suitable for all skill levels.**Workshop** Informative and interactive discussions with current students and academics.

# Art



For more information visit  
[rmit.edu.au/art](http://rmit.edu.au/art)

	Location	Activities	Time	Duration	Study level
Arts Management	<a href="#">Building 2 Level 2</a>	<b>Info point</b> Display	10.00am	All day	Master
Creative and Cultural Production	<a href="#">Building 2 Level 2</a>	<b>Info point</b> Display	10.00am	All day	Graduate Certificate
Fine Art	<a href="#">Building 2 Level 2</a>	<b>Info point</b>	10.00am	All day	Bachelor/Honours/ Master
	<a href="#">Building 16 Level 1 Room 1</a>	<b>Presentation</b>	10.00am, 1.30pm	30 mins	Bachelor
Fine Art – Ceramics	<a href="#">Building 2 Level 1 Room 2</a>	<b>Info point</b> Display	10.00am	All day	Bachelor
Fine Art – Drawing	<a href="#">Building 4 Level 3 Room 1</a>	<b>Info point</b> Display	10.00am	All day	Bachelor
	<a href="#">Building 4 Level 4 Room 1</a>	<b>Info point</b> Display	10.00am	All day	Bachelor
	<a href="#">Building 4 Level 5 Room 5</a>	<b>Info point</b> Display	10.00am	All day	Bachelor
	<a href="#">Building 4 Level 5 Room 5</a>	<b>Presentation</b>	11.30am	20 mins	Bachelor
Fine Art – Gold and Silversmithing	<a href="#">Building 2 Level 1 Rooms 3 and 4</a>	<b>Info point</b> Display	10.00am	All day	Bachelor
	<a href="#">Building 2 Level 1 Room 3</a>	<b>Tour</b>	11.30am, 1.00pm, 3.00pm	15 mins	Bachelor
Fine Art – Painting	<a href="#">Building 2 Level 3 Rooms 1-3</a>	<b>Info point</b> Display	10.00am	All day	Bachelor
	<a href="#">Building 2 Level 4 Room 8</a>	<b>Info point</b> Display	10.00am	All day	Bachelor
	<a href="#">Building 2 Level 4 Room 4</a>	<b>Presentation</b>	11.00am, 2.00pm	20 mins	Bachelor
Fine Art – Print	<a href="#">Building 2 Level 3 Room 4</a>	<b>Info point</b> Display	10.00am	All day	Bachelor
	<a href="#">Building 2 Lobby</a>	<b>Tour</b>	10.30am, 12.00pm, 2.00pm	30 mins	Bachelor
Fine Art – Sculpture	<a href="#">Building 2 Level 3 Room 4</a>	<b>Info point</b> Display	10.00am	All day	Bachelor
	<a href="#">Building 2 Lobby</a>	<b>Tour</b>	10.30am, 12.00pm, 2.00pm	30 mins	Bachelor
Fine Art – Video and Sound	<a href="#">Building 2 Level 4 Room 4</a>	<b>Info point</b> Display	10.00am	All day	Bachelor

## KEY:

**Info point** Drop-in, drop-out areas where you can speak to us about your course at any time.

**Presentation** Hear from our academics on hot topics in your study area or get an overview of your course.

**Tour** Join a study area tour to discover the facilities your course will be taught in.

**Display** Exhibits and demonstrations relevant to your course or study area.

**Activity** Practical tasks and experiences suitable for all skill levels.

**Workshop** Informative and interactive discussions with current students and academics.



For more information visit  
[rmit.edu.au/art](http://rmit.edu.au/art)

## Art (continued)

	Location	Activities	Time	Duration	Study level
Photography	<a href="#">Building 2 Level 2 Room 1</a>	<b>Info point</b> Display	10.00am	All day	Bachelors/Honours/ Masters
	<a href="#">Building 16 Level 1 Room 1</a>	<b>Presentation</b>	11.30am, 3.00pm	30 mins	Bachelor
Photography – Exhibition: Robyn Beeche Award	<a href="#">Building 2 Level 2 Room 8</a>	Display	10.00am	All day	Bachelor
Photography – Fine Printing demonstration	<a href="#">Building 2 Level 2 Room 4</a>	Activity	10.00am	All day	Bachelor
Photography – Lighting Studio tour and demonstration	<a href="#">Building 2 Lobby</a>	<b>Tour</b>	10.30am, 12.30pm	45 mins	Bachelor
Photography – Portfolio advice session	<a href="#">Building 2 Level 2 Room 2</a>	<b>Workshop</b>	1.30pm	30 mins	Bachelor
Photography – Third-year students discussing their work	<a href="#">Building 2 Level 2 Room 8</a>	<b>Presentation</b>	2.00pm	30 mins	Bachelor
Photography and Digital Imaging	<a href="#">Building 94 Level 2 Room 1</a>	<b>Info point</b>	10.00am	All day	Certificate/Diploma
	<a href="#">Building 94 Level 1 Room 11</a>	<b>Presentation</b>	10.00am, 2.30pm	30 mins	Certificate/Diploma
	<a href="#">Building 94 Level 4 Room 24</a>	Display	10.00am	All day	Certificate/Diploma
	<a href="#">Building 94 Level 4 Rooms 3 and 4</a>	Display	10.30am, 12.00pm, 2.00pm	30 mins	Certificate/Diploma
Visual Art	<a href="#">Building 94 Level 2 Room 1</a>	<b>Info point</b>	10.00am	All day	Advanced Diploma/ Diploma
	<a href="#">Building 94 Level 1 Room 11</a>	<b>Presentation</b>	12.00pm	20 mins	Advanced Diploma/ Diploma
	<a href="#">Building 94 Level 6 Room 6</a>	<b>Presentation</b>	2.30pm	20 mins	Advanced Diploma/ Diploma
	<a href="#">Building 94 Level 6 Room 12</a>	Display	10.00am	All day	Advanced Diploma/ Diploma
	<a href="#">Building 94 Level 6 Room 14</a>	Display	10.00am	All day	Advanced Diploma/ Diploma
	<a href="#">Building 94 Level 6 Room 23</a>	Display	10.00am	All day	Advanced Diploma/ Diploma
	<a href="#">Building 94 Level 6 Room 26</a>	Display	10.00am	All day	Advanced Diploma/ Diploma
	<a href="#">Building 94 Level 6 Room 29</a>	Display	10.00am	All day	Advanced Diploma/ Diploma
Visual Art Studio tour	<a href="#">Building 94 Level 6 Room 37</a>	Display	10.00am	All day	Advanced Diploma/ Diploma
	<a href="#">Building 94 Level 6 Room 6</a>	<b>Tour</b>	10.30am, 11.30am, 12.30pm, 1.30pm	30 mins	Advanced Diploma/ Diploma

**Click on building location to open Google Maps****KEY:****Info point** Drop-in, drop-out areas where you can speak to us about your course at any time.**Presentation** Hear from our academics on hot topics in your study area or get an overview of your course.**Tour** Join a study area tour to discover the facilities your course will be taught in.

Display Exhibits and demonstrations relevant to your course or study area.

Activity Practical tasks and experiences suitable for all skill levels.

Workshop Informative and interactive discussions with current students and academics.

For more information visit  
[rmit.edu.au/biomedicalscience](http://rmit.edu.au/biomedicalscience)

# Biomedical Science

	Location	Activities	Time	Duration	Study level
Biomedical Sciences	<a href="#">Building 51</a> <a href="#">Level 2 Room 2</a>	Info point	10.00am	All day	Bachelor
Laboratory Medicine	<a href="#">Building 51</a> <a href="#">Level 2 Room 2</a>	Info point	10.00am	All day	Bachelor
Pharmaceutical Science	<a href="#">Building 51</a> <a href="#">Level 2 Room 2</a>	Info point	10.00am	All day	Bachelor

For more information visit  
[rmit.edu.au/building](http://rmit.edu.au/building)

# Building

	Location	Activities	Time	Duration	Study level
Air-conditioning and Refrigeration	<a href="#">Building 78</a> <a href="#">Level 1 Room 1</a>	Info point	10.00am	All day	Apprenticeship
	<a href="#">Building 78</a> <a href="#">Level 1 Room 1</a>	Display	10.00am	All day	Apprenticeship
	<a href="#">Building 78</a> <a href="#">Level 1 Room 1</a>	Tour	11.30am, 1.30pm	20 mins	Apprenticeship
Building and Construction	<a href="#">Building 8</a> <a href="#">Level 8 Room 22</a>	Info point	10.00am	All day	Diploma
	<a href="#">Building 8</a> <a href="#">Level 8 Rooms 44/47</a>	Presentation	11.30am, 2.00pm	30 mins	Diploma
Carpentry	<a href="#">Building 78</a> <a href="#">Level 1 Room 1</a>	Info point	10.00am	All day	Apprenticeship
	<a href="#">Building 70</a> <a href="#">Level 2 Room 2</a>	Tour	11.30am, 1.30pm	20 mins	Apprenticeship
Construction Management	<a href="#">Building 8</a> <a href="#">Level 8 Room 22</a>	Info point	10.00am	All day	Bachelor/Honours
	<a href="#">Building 8</a> <a href="#">Level 8 Room 44/47</a>	Presentation	12.00pm, 2.30pm	30 mins	Bachelor/Honours
Electrical and Instrumentation	<a href="#">Building 78</a> <a href="#">Level 1 Room 1</a>	Info point	10.00am	All day	Apprenticeship
	<a href="#">Building 78</a> <a href="#">Level 1 Room 1</a>	Tour	10.30am, 2.00pm	20 mins	Apprenticeship
Plumbing	<a href="#">Building 78</a> <a href="#">Level 1 Room 1</a>	Info point	10.00am	All day	Apprenticeship
	<a href="#">Building 70</a> <a href="#">Level 1 Room 18</a>	Tour	11.00am, 1.00pm	20 mins	Apprenticeship
Program presentation	<a href="#">Building 8</a> <a href="#">Level 8 Rooms 44/47</a>	Presentation	2.30pm	30 mins	Bachelor/Honours
Project Management	<a href="#">Building 8</a> <a href="#">Level 8 Room 22</a>	Info point	10.00am	All day	Bachelor/Honours
	<a href="#">Building 8</a> <a href="#">Level 8 Rooms 44/47</a>	Presentation	10.15am, 12.45pm	45 mins	Bachelor/Honours
Surveying	<a href="#">Alumni Courtyard</a>	Info point	10.00am	All day	Certificate/Diploma
	<a href="#">Building 12</a> <a href="#">Level 12 Room 2</a>	Presentation	2.20pm	30 mins	Certificate/Diploma

**KEY:****Info point** Drop-in, drop-out areas where you can speak to us about your course at any time.**Presentation** Hear from our academics on hot topics in your study area or get an overview of your course.**Tour** Join a study area tour to discover the facilities your course will be taught in.**Display** Exhibits and demonstrations relevant to your course or study area.**Activity** Practical tasks and experiences suitable for all skill levels.**Workshop** Informative and interactive discussions with current students and academics.

For more information visit  
[rmit.edu.au/business](http://rmit.edu.au/business)

# Business

	Location	Activities	Time	Duration	Study level
Accounting	<a href="#">Building 80 Level 7 Room 9</a>	Info point	10.00am	All day	Bachelor
	<a href="#">Building 80 Level 7 Room 1U</a>	Presentation	11.40am, 1.40pm	30 mins	Bachelor
Accounting and Bookkeeping	<a href="#">Building 80 Level 7 Room 9</a>	Info point	10.00am	All day	Certificate/Diploma/ Advanced Diploma
	<a href="#">Building 80 Level 9 Room 11</a>	Presentation	10.15am, 2.15pm	30 mins	Certificate/Diploma/ Advanced Diploma
Admissions and Pathways	<a href="#">Building 80 Level 7 Foyer</a>	Info point	10.00am	All day	Bachelor
Behavioural Business Lab	<a href="#">Building 80 Level 6 Room 7</a>	Activity	11.30am, 12.30pm, 2.00pm	30 mins	Bachelor
Blockchain Enabled Business	<a href="#">Building 80 Level 6 Room 6</a>	Info point	10.00am	All day	Bachelor
	<a href="#">Building 80 Level 8 Room 11</a>	Presentation	10.50am, 12.50pm	20 mins	Bachelor
Blockchain Lab	<a href="#">Building 80 Level 6 Room 7</a>	Activity	12.00pm, 1.30pm, 2.30pm	30 mins	Bachelor
Business and Commerce	<a href="#">Building 80 Level 7 Room 8</a>	Info point	10.00am	All day	Associate Degree/ Diploma
	<a href="#">Building 80 Level 9 Room 9</a>	Presentation	11.30am	30 mins	Diploma
	<a href="#">Building 80 Level 9 Room 9</a>	Presentation	2.45pm	30 mins	Associate Degree/ Diploma
Business and Technology	<a href="#">Building 80 Level 6 Room 3</a>	Info point	10.00am	All day	Bachelor
	<a href="#">Building 80 Level 8 Room 10</a>	Presentation	11.10am, 1.40pm	20 mins	Bachelor
Business clubs and societies	<a href="#">Building 80 Level 7 Foyer</a>	Info point	10.00am	All day	Bachelor
Business Information Systems	<a href="#">Building 80 Level 6 Room 3</a>	Info point	10.00am	All day	Bachelor
	<a href="#">Building 80 Level 8 Room 11</a>	Presentation	11.50am, 1.50pm	20 mins	Bachelor
Business/Business Professional Practice	<a href="#">Building 80 Level 7 Room 8</a>	Info point	10.00am	All day	Bachelor
	<a href="#">Building 80 Level 7 Room 1U</a>	Presentation	10.20am, 12.20pm, 2.20pm	30 mins	Bachelor
Commerce	<a href="#">Building 80 Level 7 Room 2</a>	Info point	10.00am	All day	Bachelor
	<a href="#">Building 80 Level 7 Room 1U</a>	Presentation	11.00am, 1.00pm, 3.00pm	30 mins	Bachelor
Economics	<a href="#">Building 80 Level 6 Room 6</a>	Info point	10.00am	All day	Bachelor
	<a href="#">Building 80 Level 8 Room 10</a>	Presentation	10.40am, 1.10pm	20 mins	Bachelor

**KEY:****Info point** Drop-in, drop-out areas where you can speak to us about your course at any time.**Presentation** Hear from our academics on hot topics in your study area or get an overview of your course.**Tour** Join a study area tour to discover the facilities your course will be taught in.**Display** Exhibits and demonstrations relevant to your course or study area.**Activity** Practical tasks and experiences suitable for all skill levels.**Workshop** Informative and interactive discussions with current students and academics.





For more information visit  
[rmit.edu.au/business](https://rmit.edu.au/business)

## Business (continued)

	Location	Activities	Time	Duration	Study level
Entrepreneurship	<a href="#">Building 80 Level 7 Room 7</a>	Info point	10.00am	All day	Bachelor
	<a href="#">Building 80 Level 8 Room 10</a>	Presentation	11.40am, 2.10pm	20 mins	Bachelor
Entrepreneurship and New Business	<a href="#">Building 80 Level 7 Room 7</a>	Info point	10.00am	All day	Certificate
	<a href="#">Building 80 Level 9 Room 11</a>	Presentation	12.00pm	30 mins	Certificate
Essendon Football Club handball skills test	Bowen St	Activity	10.00am	All day	Diploma
Finance	<a href="#">Building 80 Level 7 Room 9</a>	Info point	10.00am	All day	Bachelor
	<a href="#">Building 80 Level 8 Room 10</a>	Presentation	10.10am, 12.40pm, 2.40pm	20 mins	Bachelor
Finance: RMIT Trading Facility	<a href="#">Building 80 Level 4 Room 12</a>	Workshop	10.00am	Every 30 mins	Bachelor
Financial Planning	<a href="#">Building 80 Level 7 Room 9</a>	Info point	10.00am	All day	Bachelor
	<a href="#">Building 80 Level 8 Room 11</a>	Presentation	10.20am, 12.30pm	20 mins	Bachelor
Global Business	<a href="#">Building 80 Level 7 Room 7</a>	Info point	10.00am	All day	Bachelor
	<a href="#">Building 80 Level 8 Room 12</a>	Presentation	10.30am, 1.10pm	20 mins	Bachelor
Human Resource Management	<a href="#">Building 80 Level 7 Room 6</a>	Info point	10.00am	All day	Bachelor
	<a href="#">Building 80 Level 8 Room 12</a>	Presentation	11.00am, 1.40pm	20 mins	Bachelor
Industry Connected	<a href="#">Building 80 Level 7 Room 8</a>	Info point	10.00am	All day	Bachelor
Leadership and Management (Sports)	<a href="#">Building 80 Level 7 Room 6</a>	Info point	10.00am	All day	Diploma
	<a href="#">Building 80 Level 9 Room 7</a>	Presentation	10.30am	30 mins	Diploma
Logistics	<a href="#">Building 80 Level 6 Room 4</a>	Info point	10.00am	All day	Diploma
	<a href="#">Building 80 Level 9 Room 7</a>	Presentation	1.30pm	30 mins	Diploma
Logistics and Supply Chain	<a href="#">Building 80 Level 6 Room 4</a>	Info point	10.00am	All day	Bachelor
	<a href="#">Building 80 Level 8 Room 11</a>	Presentation	11.20am, 1.20pm	20 mins	Bachelor
Management and Change	<a href="#">Building 80 Level 7 Room 6</a>	Info point	10.00am	All day	Bachelor
	<a href="#">Building 80 Level 8 Room 12</a>	Presentation	11.30am, 2.10pm	20 mins	Bachelor

**Click on building location to open Google Maps**

### KEY:

**Info point** Drop-in, drop-out areas where you can speak to us about your course at any time.

**Presentation** Hear from our academics on hot topics in your study area or get an overview of your course.

**Tour** Join a study area tour to discover the facilities your course will be taught in.

**Display** Exhibits and demonstrations relevant to your course or study area.

**Activity** Practical tasks and experiences suitable for all skill levels.

**Workshop** Informative and interactive discussions with current students and academics.

For more information visit  
[rmit.edu.au/business](http://rmit.edu.au/business)

## Business (continued)

	Location	Activities	Time	Duration	Study level
Marketing	<a href="#">Building 80 Level 6 Room 5</a>	Info point	10.00am	All day	Bachelor
	<a href="#">Building 80 Level 4 Room 6</a>	Presentation	11.10am, 12.20pm, 1.30pm	20 mins	Bachelor
Marketing and Communication	<a href="#">Building 80 Level 6 Room 5</a>	Info point	10.00am	All day	Certificate/Diploma
	<a href="#">Building 80 Level 9 Room 9</a>	Presentation	12.45pm	30 mins	Certificate/Diploma
Melbourne Cricket Education Academy Bowling Tunnel	<a href="#">Building 8 Level 4 Room 12</a>	Activity	10.00am	All day	Diploma
Mortgage Broking	<a href="#">Building 80 Level 7 Room 9</a>	Info point	10.00am	All day	Diploma
	<a href="#">Building 80 Level 9 Room 11</a>	Presentation	11.00am	30 mins	Diploma
Project Management Practice	<a href="#">Building 8 Level 8 Room 24</a>	Info point	10.00am	All day	Certificate/Diploma
	<a href="#">Building 8 Level 8 Rooms 44/47</a>	Presentation	10.15am	45 mins	Certificate/Diploma
	<a href="#">Building 8 Level 8 Rooms 44/47</a>	Presentation	1.30pm	30 mins	Certificate/Diploma
Social Impact	<a href="#">Building 80 Level 6 Room 5</a>	Info point	10.00am	All day	Bachelor
	<a href="#">Building 80 Level 8 Room 10</a>	Presentation	12.10pm	20 mins	Bachelor
Social Media Marketing	<a href="#">Building 80 Level 6 Room 5</a>	Info point	10.00am	All day	
	<a href="#">Building 80 Level 9 Room 9</a>	Presentation	1.30pm	30 mins	Certificate/Diploma
Strategy and Innovation	<a href="#">Building 80 Level 6 Room 5</a>	Info point	10.00am	All day	Bachelor
	<a href="#">Building 80 Level 8 Room 12</a>	Presentation	12.00pm, 2.40pm	20 mins	Bachelor
Supply Chain and Logistics	<a href="#">Building 80 Level 6 Room 4</a>	Info point	10.00am	All day	Bachelor
	<a href="#">Building 80 Level 8 Room 11</a>	Presentation	11.20am, 1.20pm	20 mins	Bachelor
Work-Integrated Learning	<a href="#">Building 80 Level 7 Room 8</a>	Info point	10.00am	All day	Bachelor
Virtual Reality – Soft Skills for Business and Law	<a href="#">Building 80 Level 6 Room 9</a>	Activity	10.00am	All day	Bachelor

**Click on building location to open Google Maps****KEY:****Info point** Drop-in, drop-out areas where you can speak to us about your course at any time.**Presentation** Hear from our academics on hot topics in your study area or get an overview of your course.**Tour** Join a study area tour to discover the facilities your course will be taught in.**Display** Exhibits and demonstrations relevant to your course or study area.**Activity** Practical tasks and experiences suitable for all skill levels.**Workshop** Informative and interactive discussions with current students and academics.

For more information visit  
[rmit.edu.au/communication](http://rmit.edu.au/communication)

# Communication

	Location	Activities	Time	Duration	Study level
Creative Writing	<a href="#">Building 14 Level 2 Room 131</a>	Info point	10.00am	All day	Bachelor
	<a href="#">Building 10 Level 3 Room 59</a>	Presentation	2.00pm	45 mins	Bachelor
Journalism	<a href="#">Building 14 Level 2 Room 131</a>	Info point	10.00am	All day	Bachelor
Journalism industry panel	<a href="#">Building 10 Level 3 Room 59</a>	Presentation	12.30pm	30 mins	Bachelor
Journalism, Media and Professional Communication	<a href="#">Building 16 Level 5 Room 1</a>	Presentation	10.50am, 2.15pm	45 mins	Bachelor
Media	<a href="#">Building 12 Level 2 Room 104</a>	Info point	10.00am	All day	Bachelor
Media Program panel	<a href="#">Building 10 Level 3 Room 59</a>	Presentation	1.15pm	30 mins	Bachelor
Professional Communication (Advertising)	<a href="#">Building 14 Level 2 Room 131</a>	Info point	10.00am	All day	Bachelor
	<a href="#">Building 12 Level 3 Room 96</a>	Presentation	12.00pm	30 mins	Bachelor
Professional Communication (Digital Communication)	<a href="#">Building 14 Level 2 Room 131</a>	Info point	10.00am	All day	Bachelor
	<a href="#">Building 12 Level 3 Room 96</a>	Presentation	1.30pm	30 mins	Bachelor
Professional Communication (Public Relations)	<a href="#">Building 14 Level 2 Room 131</a>	Info point	10.00am	All day	Bachelor
	<a href="#">Building 12 Level 3 Room 96</a>	Presentation	12.45pm	30 mins	Bachelor
Professional Writing and Editing	<a href="#">Building 94 Level 4 Room 27</a>	Info point	10.00am	All day	Certificate/ Associate Degree
Professional Writing and Editing, Screenwriting and Creative Writing	<a href="#">Building 94 Level 1 Room 6</a>	Presentation	10.45am	45 mins	Bachelor/Associate Degree/Advanced Diploma/Certificate
	<a href="#">Building 94 Level 1 Room 11</a>	Presentation	1.30pm	45 mins	Bachelor/Associate Degree/Advanced Diploma/Certificate
Screenwriting	<a href="#">Building 94 Level 4 Room 26</a>	Info point	10.00am	All day	Advanced Diploma

Click on building location to open Google Maps

**KEY:**

**Info point** Drop-in, drop-out areas where you can speak to us about your course at any time.

**Presentation** Hear from our academics on hot topics in your study area or get an overview of your course.

**Tour** Join a study area tour to discover the facilities your course will be taught in.

**Display** Exhibits and demonstrations relevant to your course or study area.

**Activity** Practical tasks and experiences suitable for all skill levels.

**Workshop** Informative and interactive discussions with current students and academics.



For more information visit  
[rmit.edu.au/design](http://rmit.edu.au/design)

# Design

	Location	Activities	Time	Duration	Study level
Animation	<a href="#">Building 7</a> <a href="#">Level 3 Rooms 23 and 24</a>	Info point	10.00am	All day	Bachelor
	<a href="#">Building 7</a> <a href="#">Level 3 Rooms 9, 10 and 14</a>	Display	10.00am	All day	Bachelor
Animation, Digital Media and Game Design (focusing on Bachelor and Pathways)	<a href="#">Building 16</a> <a href="#">Level 5 Room 1</a>	Presentation	11.45am, 3.10pm	45 mins	Certificate/Diploma/ Advanced Diploma/ Bachelor
Animation, Gaming and Visual Effects	<a href="#">Building 10</a> <a href="#">Level 2 Room 62</a>	Info point	10.00am	All day	Certificate/Diploma/ Advanced Diploma
	<a href="#">Building 94</a> <a href="#">Level 2 Room 1</a>	Info point	10.00am	All day	Certificate/Diploma/ Advanced Diploma
	<a href="#">Building 94</a> <a href="#">Level 1 Room 6</a>	Presentation	2.30pm	30 mins	Certificate/Diploma/ Advanced Diploma
Communication Design	<a href="#">Building 94</a> <a href="#">Level 6 Room 24</a>	Display	10.00am	All day	Certificate/Diploma/ Advanced Diploma
	<a href="#">Building 9</a> <a href="#">Level 3 Room 5A/B</a>	Info point	10.00am	All day	Bachelor
	<a href="#">Building 9</a> <a href="#">Level 3 Rooms 4A/B and 6A/B</a>	Display	10.00am	All day	Bachelor
Communication Design – visit the Makerspace	<a href="#">Building 9</a> <a href="#">Level 3 Room 3</a>	Tour	10.00am	All day	Bachelor
Communication Design and Industrial Design	<a href="#">Building 16</a> <a href="#">Level 5 Room 1</a>	Presentation	10.10am, 1.35pm	30 mins	Bachelor/Honours
Digital Media	<a href="#">Building 9</a> <a href="#">Level 3 Rooms 8 and 12</a>	Info point	10.00am	All day	Bachelor
	<a href="#">Building 9</a> <a href="#">Level 3 Room 10</a>	Display	10.00am	All day	Bachelor
Digital Media – Black Box Audio Playback	<a href="#">Building 12 Level 2 Room 103</a>	Display	10.00am	All day	Bachelor
Furniture Design	<a href="#">Building 94</a> <a href="#">Level 2 Room 44</a>	Info point	10.00am	All day	Associate Degree
	<a href="#">Building 16</a> <a href="#">Level 1 Room 1</a>	Presentation	1.10pm	20 mins	Associate Degree
	<a href="#">Building 71</a> <a href="#">Level 2 Rooms 9 and 11</a>	Tour Display Workshop	10.00am	All day	Associate Degree
Games Design	<a href="#">Building 9</a> <a href="#">Level 3 Rooms 7 and 9</a>	Info point	10.00am	All day	Bachelor
	<a href="#">Building 9</a> <a href="#">Level 3 Room 11</a>	Display	10.00am	All day	Bachelor
Graphic Design	<a href="#">Building 94</a> <a href="#">Level 2 Room 1</a>	Info point	10.00am	All day	Certificate/Diploma/ Associate Degree
	<a href="#">Building 16</a> <a href="#">Level 1 Room 1</a>	Presentation	12.30pm	20 mins	Certificate/Diploma/ Associate Degree
Industrial Design – visit the Workshop	<a href="#">Building 45</a> <a href="#">Level 1 Room 5</a>	Info point	10.00am	All day	Bachelor/Honours
	<a href="#">Building 45</a> <a href="#">Level 1 Room 8</a>	Tour	10.00am	All day	Bachelor/Honours
	<a href="#">Building 45</a> <a href="#">Level 1 Room 5A/B/C/D</a>	Display	10.00am	All day	Bachelor/Honours

**KEY:****Info point** Drop-in, drop-out areas where you can speak to us about your course at any time.**Presentation** Hear from our academics on hot topics in your study area or get an overview of your course.**Tour** Join a study area tour to discover the facilities your course will be taught in.**Display** Exhibits and demonstrations relevant to your course or study area.**Activity** Practical tasks and experiences suitable for all skill levels.**Workshop** Informative and interactive discussions with current students and academics.

## Design (continued)



For more information visit  
[rmit.edu.au/design](http://rmit.edu.au/design)

	Location	Activities	Time	Duration	Study level
Interior Decoration and Design	<a href="#">Building 94 Level 2 Room 44</a>	Info point	10.00am	All day	Certificate/Diploma/ Associate Degree
	<a href="#">Building 94 Level 1 Room 6</a>	Presentation	11.35am	40 mins	Certificate/Diploma
	<a href="#">Building 94 Level 1 Room 6</a>	Presentation	1.30pm	30 mins	Certificate/Diploma
Interior Decoration and Design, and Furniture Design	<a href="#">Building 94 Level 1 Room 6</a>	Presentation	12.15pm, 2.00pm	30 mins	Associate Degree
Master of Communication Design	<a href="#">Building 9 Level 3 Room a2</a>	Info point	10.00am	All day	Postgraduate
Master of Design Innovation and Technology	<a href="#">Building 45 Level 1 Room 5</a>	Info point	10.00am	All day	Postgraduate
Product Design	<a href="#">Building 94 Level 2 Room 1</a>	Info point	10.00am	All day	Diploma
	<a href="#">Building 16 Level 1 Room 1</a>	Presentation	12.50pm	20 mins	Diploma

Click on building location to open Google Maps

### Visit the Future Folds origami exhibition at Design Hub Gallery

Join us at Building 100, Level 2 (no room needed as the gallery is the entire floor) to hear from co-curator Malte Wagenfeld about the Master of Design Innovation and Technology program and exhibition partnership.

See RMIT Culture on page 7 for further details.

## Education



For more information visit  
[rmit.edu.au/education](http://rmit.edu.au/education)

	Location	Activities	Time	Duration	Study level
Access and Inclusion	<a href="#">Building 8 Level 4 Room 11</a>	Info point	10.00am	All day	N/A
Education degrees overview	Bowen St	Info point	10.00am	All day	Bachelor/Postgraduate
	<a href="#">Building 8 Level 11 Room 68</a>	Presentation	10.30am, 12.00pm, 2.00pm	30 mins	All levels of study
Education Support	<a href="#">Building 78 Level 1 Room 1</a>	Info point	10.00am	All day	Certificate
Teacher Education Preparation	<a href="#">Building 78 Level 1 Room 1</a>	Info point	10.00am	All day	Certificate/Diploma
Tertiary Preparation	<a href="#">Building 78 Level 1 Room 1</a>	Info point	10.00am	All day	Certificate
Training and Assessment	<a href="#">Building 78 Level 1 Room 1</a>	Info point	10.00am	All day	Certificate
	<a href="#">Building 51 Level 5 Room 1</a>	Presentation	12.30pm	30 mins	Certificate

#### KEY:

**Info point** Drop-in, drop-out areas where you can speak to us about your course at any time.

**Presentation** Hear from our academics on hot topics in your study area or get an overview of your course.

**Tour** Join a study area tour to discover the facilities your course will be taught in.

**Display** Exhibits and demonstrations relevant to your course or study area.

**Activity** Practical tasks and experiences suitable for all skill levels.

**Workshop** Informative and interactive discussions with current students and academics.

For more information visit  
[rmit.edu.au/engineering](http://rmit.edu.au/engineering)

# Engineering

	Location	Activities	Time	Duration	Study level
Engineering degrees overview	<a href="#">Building 80 Level 1 Room 2</a>	Presentation	10.30am, 12.00pm, 1.30pm	30 mins	Bachelor
	<a href="#">Building 80 Level 2 Room 2</a>	Presentation	11.00am, 12.30pm, 2.00pm	30 mins	Bachelor
	<a href="#">Building 80 Level 2 Room 7</a>	Presentation	10.00am, 11.30am, 1.00pm, 2.30pm	30 mins	Bachelor
Aerospace Engineering and Aviation	<a href="#">A'Beckett Urban Square</a>	Info point	10.00am	All day	Bachelor
Applied Technologies and Advanced Manufacturing	<a href="#">A'Beckett Urban Square</a>	Info point	10.00am	All day	Associate Degree/ Diploma
	<a href="#">Building 80 Level 2 Room 2</a>	Presentation	2.30pm	30 mins	Associate Degree/ Diploma
Aviation	<a href="#">Building 55 Level 2 Room 5</a>	Tour	11.30am	30 mins	Associate Degree/ Diploma
	<a href="#">Building 80 Level 2 Room 2</a>	Presentation	11.45am, 1.15pm	30 mins	Bachelor
Aviation Academy	<a href="#">A'Beckett Urban Square</a>	Info point	10.00am	All day	Bachelor
Biomedical Engineering	<a href="#">A'Beckett Urban Square</a>	Info point	10.00am	All day	Bachelor
Biomedical Engineering: The Responsive Artificial Hand	<a href="#">Building 10 Level 9 Room 12</a>	Display	10.00am	All day	Bachelor
Chemical Engineering	<a href="#">A'Beckett Urban Square</a>	Info point	10.00am	All day	Bachelor
Chemical & Environmental Engineering – demonstrations	<a href="#">Building 55 Level 4 Room 5</a>	Display	10.00am	All day	Bachelor
Civil Engineering	<a href="#">A'Beckett Urban Square</a>	Info point	10.00am	All day	Bachelor
Civil Engineering: Bridge the Gap	<a href="#">A'Beckett Urban Square</a>	Display	10.00am	All day	Bachelor
Crash testing	<a href="#">A'Beckett Urban Square</a>	Display	10.00am	All day	Bachelor
Electrical Engineering	<a href="#">A'Beckett Urban Square</a>	Info point	10.00am	All day	Bachelor
Electronic and Computer Systems Engineering	<a href="#">A'Beckett Urban Square</a>	Info point	10.00am	All day	Bachelor
Electronics and Communications Engineering	<a href="#">A'Beckett Urban Square</a>	Info point	10.00am	All day	Associate Degree/ Advanced Diploma
Engineering (Aeronautical)	<a href="#">A'Beckett Urban Square</a>	Info point	10.00am	All day	Associate Degree/ Advanced Diploma
Engineering (Mechanical)	<a href="#">A'Beckett Urban Square</a>	Info point	10.00am	All day	Associate Degree/ Advanced Diploma

**KEY:****Info point** Drop-in, drop-out areas where you can speak to us about your course at any time.**Presentation** Hear from our academics on hot topics in your study area or get an overview of your course.**Tour** Join a study area tour to discover the facilities your course will be taught in.**Display** Exhibits and demonstrations relevant to your course or study area.**Activity** Practical tasks and experiences suitable for all skill levels.**Workshop** Informative and interactive discussions with current students and academics.



For more information visit  
[rmit.edu.au/engineering](http://rmit.edu.au/engineering)

# Engineering (continued)

	Location	Activities	Time	Duration	Study level
Engineering Technology					
<ul style="list-style-type: none"> <li>■ Advanced Manufacturing and Mechatronics</li> <li>■ Aerospace</li> <li>■ Civil</li> <li>■ Computer and Network</li> <li>■ Electrical and Electronics</li> <li>■ Mechanical</li> </ul>	<a href="#">A'Beckett Urban Square</a>	<b>Info point</b>	10.00am	All day	Associate Degree/ Advanced Diploma
Engineering Technology Electronics and Communications	<a href="#">Building 80 Level 1 Room 2</a>	<b>Presentation</b>	11.00am, 2.00pm	30 mins	Associate Degree/ Advanced Diploma
Environmental Engineering	<a href="#">A'Beckett Urban Square</a>	<b>Info point</b>	10.00am	All day	Bachelor
Engineering with People: Welcome to Satilla	<a href="#">Building 55 Level 4 Room 5</a>	<b>Display</b>	10.00am	All day	Bachelor
Manufacturing – 3D Printing in Action	<a href="#">A'Beckett Urban Square</a>	<b>Display</b>	10.00am	All day	Bachelor
Mechanical Engineering	<a href="#">A'Beckett Urban Square</a>	<b>Info point</b>	10.00am	All day	Bachelor
Mechatronics and Manufacturing Engineering	<a href="#">A'Beckett Urban Square</a>	<b>Info point</b>	10.00am	All day	Bachelor
Watch Innovative Engineering: Autonomous Cars	<a href="#">Building 55 Level 4 Room 5</a>	<b>Display</b>	10.00am	All day	Bachelor
Software Engineering	<a href="#">A'Beckett Urban Square</a>	<b>Info point</b>	10.00am	All day	Bachelor
Vocational Education Civil Engineering	<a href="#">Building 56 Level 4 Room 87</a>	<b>Activity</b>	11.00am	60 mins	Advanced Diploma
Vocational Education Engineering (ALL)	<a href="#">Building 57 Level 2 Room 14</a>	<b>Tour</b>	2.45pm	30 mins	Associate Degree/ Advanced Diploma
Vocational Education Engineering (Mechanical, Aeronautical, Civil Engineering Design)	<a href="#">Building 80 Level 1 Room 2</a>	<b>Presentation</b>	10.00am, 12.30pm	30 mins	Advanced Diploma
Women in STEM	<a href="#">Building 10 Level 4 Room 51 (near Student Connect)</a>	<b>Info point</b>	10.00am	All day	All levels of study
	<a href="#">Building 80 Level 10 Room 17</a>	<b>Presentation</b>	11.30am, 12.30pm	30 mins	All levels of study
Explore Advanced Electrical, Electronic, Computer & Communication Engineering	<a href="#">Building 57 Level 1 Room 13</a>	<b>Display</b>	10.00am	All day	Bachelor

[Click on building location to open Google Maps](#)

## Discover Engineering at A'Beckett Urban Square

Join us for an immersive experience that will ignite your curiosity and inspire your mind. Engage in inspiring conversations, dive into hands-on VR technology, and explore the vast world of engineering.

### KEY:

**Info point** Drop-in, drop-out areas where you can speak to us about your course at any time.

**Presentation** Hear from our academics on hot topics in your study area or get an overview of your course.

**Tour** Join a study area tour to discover the facilities your course will be taught in.

**Display** Exhibits and demonstrations relevant to your course or study area.

**Activity** Practical tasks and experiences suitable for all skill levels.

**Workshop** Informative and interactive discussions with current students and academics.

## Environment



For more information visit  
[rmit.edu.au/environment](http://rmit.edu.au/environment)

	Location	Activities	Time	Duration	Study level
Environment and Society	<a href="#">Building 80 Level 3 Room 14</a>	Info point	10:00am	All day	Bachelor
	<a href="#">Building 80 Level 3 Room 15</a>	Presentation	12:00pm, 2:45pm	30 mins	Bachelor
Environment and Society – Environmental Science	<a href="#">Building 80 Level 3 Room 14</a>	Info point	10:00am	All day	Bachelor
	<a href="#">Building 80 Level 3 Room 15</a>	Presentation	12:00pm, 2:45pm	30 mins	Bachelor
Sustainability and Urban Planning – Career Q&A with industry	<a href="#">Building 80 Level 3 Room 21</a>	Workshop	10:00am	All day	Bachelor
Sustainability and Urban Planning – student projects	<a href="#">Building 80 Level 3 Room 12</a>	Display	9:30am	All day	Bachelor
Urban and Regional Planning	<a href="#">Building 80 Level 3 Room 14</a>	Info point	10:00am	All day	Bachelor
	<a href="#">Building 80 Level 3 Room 15</a>	Presentation	10:45am, 1:15pm	30 mins	Bachelor

Click on building location to open Google Maps

## Fashion



For more information visit  
[rmit.edu.au/fashion](http://rmit.edu.au/fashion)

	Location	Activities	Time	Duration	Study level
Fashion and Textiles Design	<a href="#">Building 8 Level 12 Room 11</a>	Info point	10:00am	All day	Bachelor/Honours/ Master
Fashion and Textiles Design Honours – open studio	<a href="#">Building 8 Level 12 Room 10</a>	Display	10:00am	All day	Bachelor/Honours/ Master
Fashion <ul style="list-style-type: none"> <li>■ Business and Retail</li> <li>■ Design and Technology</li> <li>■ Fashion Styling</li> <li>■ Textiles and Footwear</li> </ul>	<a href="#">Building 94 Level 2 Room 1</a>	Info point	10:00am	All day	Certificate/Diploma/ Associate Degree
Fashion Design – open studio	<a href="#">Building 8 Level 12 Room 9</a>	Display	10:00am	All day	Bachelor/Honours/ Master

### Explore careers in fashion and textiles

Immerse yourself in an interactive journey through fashion and textile design, technology and enterprise. Witness live photoshoots, see behind the scenes, and engage with students as they test their work and discuss the creative process. Visit our Brunswick campus to explore the world of fashion and textiles at RMIT.

Refer to page 44 for further information.

#### KEY:

**Info point** Drop-in, drop-out areas where you can speak to us about your course at any time.

**Presentation** Hear from our academics on hot topics in your study area or get an overview of your course.

**Tour** Join a study area tour to discover the facilities your course will be taught in.

**Display** Exhibits and demonstrations relevant to your course or study area.

**Activity** Practical tasks and experiences suitable for all skill levels.

**Workshop** Informative and interactive discussions with current students and academics.

# Health



For more information visit  
[rmit.edu.au/health](http://rmit.edu.au/health)

	Location	Activities	Time	Duration	Study level
Allied Health Assistance	<a href="#">Building 51 Level 2 Room 6</a>	Info point	10.00am	All day	Certificate
Dental Assisting	<a href="#">Building 51 Level 4 Room 3</a>	Presentation	1.30pm	30 mins	Certificate
Dental Studies	<a href="#">Building 51 Level 2 Room 6</a>	Info point	10.00am	All day	Certificate/Diploma/ Advanced Diploma
Dental Technology and Dental Prosthetics	<a href="#">Building 51 Level 4 Room 3</a>	Presentation	10.30am	30 mins	Diploma/Advanced Diploma
Health Sciences	<a href="#">Building 51 Level 2 Room 6</a>	Info point	10.00am	All day	Associate Degree
Health Sciences and Allied Health Assistance	<a href="#">Building 51 Level 4 Room 3</a>	Presentation	11.45am	30 mins	Certificate/ Associate Degree
Medical Radiations	<a href="#">Building 51 Level 2 Room 2</a>	Info point	10.00am	All day	Bachelor
Myotherapy and Massage	<a href="#">Building 51 Level 2 Room 6</a>	Info point	10.00am	All day	Diploma/Advanced Diploma
	<a href="#">Building 51 Level 7 Room 8</a>	Presentation	11.00am, 1.00pm	30 mins	Diploma/Advanced Diploma
Nursing (Registered Nurse)	<a href="#">Building 51 Level 2 Room 14</a>	Info point	10.00am	All day	Bachelor
	<a href="#">Building 51 Level 6 Room 5</a>	Presentation	11.00am, 1.00pm, 2.30pm	30 mins	Bachelor
Nursing (Enrolled Nurse)	<a href="#">Building 51 Level 2 Room 14</a>	Info point	10.00am	All day	Diploma
	<a href="#">Building 51 Level 6 Room 5</a>	Presentation	10.30am, 12.30pm, 2.00pm	30 mins	Diploma
	<a href="#">Building 51 Level 4 Room 11</a>	Tour	11.30am, 1.30pm	30 mins	Diploma
Osteopathy	<a href="#">Building 51 Level 2 Room 2</a>	Info point	10.00am	All day	Bachelor
Pharmacy	<a href="#">Building 51 Level 2 Room 2</a>	Info point	10.00am	All day	Bachelor

Click on building location to open Google Maps

## KEY:

**Info point** Drop-in, drop-out areas where you can speak to us about your course at any time.

**Presentation** Hear from our academics on hot topics in your study area or get an overview of your course.

**Tour** Join a study area tour to discover the facilities your course will be taught in.

**Display** Exhibits and demonstrations relevant to your course or study area.

**Activity** Practical tasks and experiences suitable for all skill levels.

**Workshop** Informative and interactive discussions with current students and academics.



For more information visit  
[rmit.edu.au/infotech](http://rmit.edu.au/infotech)

# Information Technology

	Location	Activities	Time	Duration	Study level
Augmented and Mixed Reality Games	<a href="#">Alumni Courtyard</a>	Activity	10.00am	All day	Bachelor
Computer Science	<a href="#">Alumni Courtyard</a>	Info point	10.00am	All day	Bachelor
Computing Technologies – industry keynote	<a href="#">Building 12 Level 10 Room 2</a>	Presentation	1.10pm	30 mins	Bachelor
Computing Technologies overview: all degrees	<a href="#">Building 12 Level 10 Room 2</a>	Presentation	10.00am, 10.40am, 12.30pm, 1.50pm, 3.10pm	30 mins	Bachelor
	<a href="#">Building 12 Level 12 Room 2</a>	Presentation	10.30am, 11.10am, 11.50am	30 mins	Bachelor
Cyber Security	<a href="#">Alumni Courtyard</a>	Info point	10.00am	All day	Bachelor
Cyber Security Hackathon	<a href="#">Building 12 Level 10 Room 6</a>	Activity	10.00am	All day	Bachelor
Cybersecurity panel	<a href="#">Building 12 Level 10 Room 2</a>	Presentation	2.30pm	30 mins	Bachelor
Data Science	<a href="#">Alumni Courtyard</a>	Info point	10.00am	All day	Bachelor
Education Pathways with Apple Platforms	<a href="#">Building 14 Level 4 Room 144</a>	Workshop	11.00am, 12.00pm, 1.30pm, 2.30pm	30 mins	Bachelor
Information Technology	<a href="#">Alumni Courtyard</a>	Info point	10.00am	All day	Bachelor
Information Technology and Networking	<a href="#">Alumni Courtyard</a>	Info point	10.00am	All day	Advanced Diploma
Software Engineering	<a href="#">Alumni Courtyard</a>	Info point	10.00am	All day	Bachelor
	<a href="#">Alumni Courtyard</a>	Info point	10.00am	All day	Associate Degree/Diploma/Certificate
Vocational Education Information Technology	<a href="#">Building 12 Level 12 Room 2</a>	Presentation	10.00am	30 mins	Associate Degree/Diploma/Certificate
	<a href="#">Building 12 Level 10 Room 2</a>	Presentation	12.00pm	30 mins	Associate Degree/Diploma/Certificate
	<a href="#">Building 56 Level 4 Room 86</a>	Tour	1.30pm	30 mins	Associate Degree/Diploma/Certificate
Walert: Your Open Day FAQ Buddy	<a href="#">Alumni Courtyard</a>	Activity	10.00am	All day	Bachelor
Women in Information Technology	<a href="#">Building 12 Level 10 Room 2</a>	Presentation	11.20am	30 mins	Bachelor
Women in STEM	<a href="#">Building 10 Level 4 Room 51 (near Student Connect)</a>	Info point	10.00am	All day	All levels of study
	<a href="#">Building 80 Level 10 Room 17</a>	Presentation	11.30am, 12.30pm	30 mins	All levels of study

## Visit the Computing and Science Immersive Hub

Explore the latest advancements in technology and science. Engage with interactive experiences, inspiring talks, and innovative demonstrations. Unleash your curiosity and be amazed at the Alumni Courtyard.

## Law



For more information visit  
[rmit.edu.au/law](http://rmit.edu.au/law)

	Location	Activities	Time	Duration	Study level
Criminal Justice	<a href="#">Building 80 Level 3 Room 6</a>	Info point	10.00am	All day	Bachelor
	<a href="#">Building 80 Level 4 Room 11</a>	Presentation	10.00am, 11.15am, 12.30pm, 1.30pm, 3.00pm	30 mins	Bachelor
Criminology and Justice	<a href="#">Building 80 Level 3 Room 6</a>	Info point	10.00am	All day	Bachelor
	<a href="#">Building 80 Level 4 Room 11</a>	Presentation	10.00am, 11.15am, 12.30pm, 1.30pm, 3.00pm	30 mins	Bachelor
Criminology and Justice Studies – Work-Integrated Learning and Industry	<a href="#">Building 80 Level 3 Room 11</a>	Workshop	10.00am, 11.00am, 12.00pm, 1.00pm, 2.00pm, 3.00pm	All day	Bachelor
Criminology and Psychology	<a href="#">Building 80 Level 3 Room 6</a>	Info point	10.00am	All day	Bachelor
	<a href="#">Building 80 Level 4 Room 11</a>	Presentation	10.00am, 11.15am, 12.30pm, 1.30pm, 3.00pm	30 mins	Bachelor
Law clubs and societies	<a href="#">Building 80 Level 4 Foyer</a>	Info point	10.00am	All day	Bachelor
Law	<a href="#">Building 80 Level 4 Room 19</a>	Info point	10.00am	All day	Bachelor
	<a href="#">Building 80 Level 4 Room 6</a>	Presentation	10.30am, 11.40am, 12.50pm, 2.00pm	30 mins	Bachelor
	<a href="#">Building 80 Level 4 Room 19</a>	Tour	10.00am, 11.00am, 12.00pm, 1.00pm, 2.00pm, 3.00pm	60 mins	Bachelor
Legal and Dispute Studies	<a href="#">Building 80 Level 3 Room 5</a>	Info point	10.00am	All day	Bachelor
	<a href="#">Building 80 Level 9 Room 12</a>	Presentation	10.30am, 12.00pm, 2.00pm	30 mins	Bachelor
Legal Practice and Conveyancing	<a href="#">Building 80 Level 4 Room 19</a>	Info point	10.00am	All day	Associate Degree/ Advanced Diploma
	<a href="#">Building 80 Level 9 Room 9</a>	Presentation	10.45am	30 mins	Associate Degree/ Advanced Diploma

[Click on building location to open Google Maps](#)

## KEY:

**Info point** Drop-in, drop-out areas where you can speak to us about your course at any time.

**Presentation** Hear from our academics on hot topics in your study area or get an overview of your course.

**Tour** Join a study area tour to discover the facilities your course will be taught in.

**Display** Exhibits and demonstrations relevant to your course or study area.

**Activity** Practical tasks and experiences suitable for all skill levels.

**Workshop** Informative and interactive discussions with current students and academics.

For more information visit  
[rmit.edu.au/media](http://rmit.edu.au/media)

# Media

	Location	Activities	Time	Duration	Study level
Journalism	<a href="#">Building 14 Level 2 Room 131</a>	Info point	10.00am	All day	Bachelor
	<a href="#">Building 12 Level 2 Room 105A</a>	Display	10.00am	All day	Bachelor
Journalism industry panel	<a href="#">Building 10 Level 3 Room 59</a>	Presentation	12.30pm	30 mins	Bachelor
Journalism, Media and Professional Communication	<a href="#">Building 16 Level 5 Room 1</a>	Presentation	10.50am, 2.15pm	45 mins	Bachelor
Live Production and Technical Services	<a href="#">Building 9 Level 1 Room 24</a>	Info point	10.00am	All day	Diploma
	<a href="#">Building 94 Level 2 Room 1</a>	Info point	10.00am	All day	Diploma
	<a href="#">Building 94 Level 1 Room 11</a>	Presentation	11.30am, 1.00pm	30 mins	Diploma
Media	<a href="#">Building 12 Level 2 Room 104</a>	Info point	10.00am	All day	Bachelor
Media program panel	<a href="#">Building 10 Level 3 Room 59</a>	Presentation	1.15pm	30 mins	Bachelor
Media and Communication – minors options	<a href="#">Building 14 Level 2 Room 131</a>	Info point	10.00am	All day	Bachelor
Music (Sound Production)	<a href="#">Building 94 Level 2 Room 1</a>	Info point	10.00am	All day	Advanced Diploma/ Diploma
	<a href="#">Building 94 Level 1 Room 11</a>	Presentation	11.00am, 12.30pm, 3.00pm	30 mins	Advanced Diploma/ Diploma
	<a href="#">Building 94 Level 2 Rooms 23 and 26</a>	Display	10.00am	All day	Advanced Diploma/ Diploma
Music Industry	<a href="#">Building 14 Level 2 Room 131</a>	Info point	10.00am	All day	Bachelor
	<a href="#">Building 16 Level 1 Room 1</a>	Presentation	10.40am, 2.10pm	20 min	Bachelor
	<a href="#">Building 5 Level 3 Room 3</a>	Tour	10.00am	All day	Bachelor
Music industry demonstration – Duelling DJs/Silent Disco	<a href="#">Building 14 Level 2 Room 131</a>	Display	10.00am, 2.00pm	2 hours	Bachelor
Music industry Q&A panel	<a href="#">Building 10 Level 3 Room 59</a>	Presentation	11.45am	30 mins	Bachelor

**Click on building location to open Google Maps****KEY:****Info point** Drop-in, drop-out areas where you can speak to us about your course at any time.**Presentation** Hear from our academics on hot topics in your study area or get an overview of your course.**Tour** Join a study area tour to discover the facilities your course will be taught in.**Display** Exhibits and demonstrations relevant to your course or study area.**Activity** Practical tasks and experiences suitable for all skill levels.**Workshop** Informative and interactive discussions with current students and academics.



## Media (continued)



For more information visit  
[rmit.edu.au/media](http://rmit.edu.au/media)

	Location	Activities	Time	Duration	Study level
Screen and Media	<a href="#">Building 10 Level 2 Room 62</a>	Info point	10.00am	All day	Certificate/Diploma/ Advanced Diploma/ Associate Degree
	<a href="#">Building 94 Level 2 Room 1</a>	Info point	10.00am	All day	Certificate/Diploma/ Advanced Diploma/ Associate Degree
	<a href="#">Building 94 Level 1 Room 6</a>	Presentation	3.00pm	30 mins	Certificate/Diploma/ Advanced Diploma/ Associate Degree
	<a href="#">Building 94 Level 1 Room 11</a>	Presentation	10.30am	30 mins	Certificate/Diploma/ Advanced Diploma/ Associate Degree
	<a href="#">Building 16 Level 1 Room 1</a>	Presentation	12.00pm	30 mins	Certificate/Diploma/ Advanced Diploma/ Associate Degree
	<a href="#">Building 10 Level 2 Rooms 68 and 69</a>	Display	10.00am	All day	Certificate/Diploma/ Advanced Diploma/ Associate Degree
	<a href="#">Building 12 Level 2 Room 101</a>	Display	10.00am	All day	Certificate/Diploma/ Advanced Diploma/ Associate Degree
	<a href="#">Building 94 Level 2 Rooms 11 and 13</a>	Display	10.00am	All day	Certificate/Diploma/ Advanced Diploma/ Associate Degree

## Property



For more information visit  
[rmit.edu.au/property](http://rmit.edu.au/property)

	Location	Activities	Time	Duration	Study level
Property Development, Investment and Valuation	<a href="#">Building 8 Level 8 Room 22</a>	Info point	10.00am	All day	Bachelor/Honours
	<a href="#">Building 8 Level 8 Rooms 44/47</a>	Presentation	11.00am, 1.30pm	30 mins	Bachelor/Honours

## Psychology



For more information visit  
[rmit.edu.au/psychology](http://rmit.edu.au/psychology)

	Location	Activities	Time	Duration	Study level
Psychology	<a href="#">Building 8 Level 2 Room 3</a>	Info point	10.00am	All day	Bachelor/Honours
	<a href="#">Building 8 Level 2 Room 4</a>	Presentation	10.00am, 11.05am, 1.10pm, 2.10pm, 3.15pm	20 mins	Bachelor

### KEY:

**Info point** Drop-in, drop-out areas where you can speak to us about your course at any time.

**Presentation** Hear from our academics on hot topics in your study area or get an overview of your course.

**Tour** Join a study area tour to discover the facilities your course will be taught in.

**Display** Exhibits and demonstrations relevant to your course or study area.

**Activity** Practical tasks and experiences suitable for all skill levels.

**Workshop** Informative and interactive discussions with current students and academics.

For more information visit  
[rmit.edu.au/science](http://rmit.edu.au/science)

# Science

	Location	Activities	Time	Duration	Study level
Applied Science	<a href="#">Building 51 Level 2 Room 6</a>	Info point	10.00am	All day	Associate Degree
Applied Science	<a href="#">Building 51 Level 4 Room 3</a>	Presentation	12.45pm	30 mins	Certificate/Diploma/ Associate Degree
Laboratory Techniques	<a href="#">Building 51 Level 8 Rooms 10 and 11</a>	Presentation	1.15pm	30 mins	Certificate/Diploma/ Associate Degree
Bachelor of Science	<a href="#">Alumni Courtyard</a>	Info point	10.00am	All day	Bachelor
Bachelor of Science overview	<a href="#">Building 12 Level 13 Room 2</a>	Presentation	10.00am, 2.40pm	30 mins	Bachelor
Biotechnology and Biosciences	<a href="#">Alumni Courtyard</a>	Info point	10.00am	All day	Bachelor
	<a href="#">Building 14 Level 13 Room 8</a>	Tour	10.00am	All day	Bachelor
Chemistry	<a href="#">Alumni Courtyard</a>	Info point	10.00am	All day	Bachelor
Chemistry Lab demonstration	<a href="#">Building 14 Level 5 Room 8</a>	Display	10.00am	All day	Bachelor
Conservation and Ecosystem Management	<a href="#">Alumni Courtyard</a>	Info point	10.00am	All day	Diploma
	<a href="#">Building 12 Level 12 Room 2</a>	Presentation	2.50pm	30 mins	Diploma
Electron Microscopy in Action	<a href="#">Building 14 Level 7 Room 5</a>	Display	10.00am	All day	Bachelor
Environmental Science	<a href="#">Alumni Courtyard</a>	Info point	10.00am	All day	Bachelor
	<a href="#">Building 12 Level 13 Room 2</a>	Presentation	2.00pm	30 mins	Bachelor
	<a href="#">Building 14 Level 5 Room 9</a>	Display	10.00am	All day	Bachelor
Food Technology and Nutrition Science	<a href="#">Alumni Courtyard</a>	Info point	10.00am	All day	Bachelor
	<a href="#">Building 12 Level 12 Room 2</a>	Presentation	12.30pm	30 mins	Bachelor
Food Technology and Nutrition Bites of Tomorrow: Explore Food Technology and Nutrition	<a href="#">Alumni Courtyard</a>	Display	10.00am	All day	Bachelor
Geospatial Science Major	<a href="#">Building 12 Level 12 Room 2</a>	Presentation	1.10pm	30 mins	Bachelor
Geospatial Science: Exploring our Changing World	<a href="#">Building 14 Level 6 Room 13</a>	Workshop	10.00am	All day	Bachelor
Laboratory Techniques	<a href="#">Building 51 Level 2 Room 6</a>	Info point	10.00am	All day	Certificate/Diploma
Maths and Statistics: Unlock the Secrets	<a href="#">Alumni Courtyard</a>	Activity	10.00am	All day	Bachelor
Maths and Statistics Majors	<a href="#">Alumni Courtyard</a>	Info point	10.00am	All day	Bachelor
Physics Major	<a href="#">Alumni Courtyard</a>	Info point	10.00am	All day	Bachelor

**KEY:****Info point** Drop-in, drop-out areas where you can speak to us about your course at any time.**Presentation** Hear from our academics on hot topics in your study area or get an overview of your course.**Tour** Join a study area tour to discover the facilities your course will be taught in.**Display** Exhibits and demonstrations relevant to your course or study area.**Activity** Practical tasks and experiences suitable for all skill levels.**Workshop** Informative and interactive discussions with current students and academics.

For more information visit  
[rmit.edu.au/science](http://rmit.edu.au/science)

## Science (continued)

	Location	Activities	Time	Duration	Study level
Physics and Space demonstrations	<a href="#">Building 14 Level 5 Room 11</a>	Display	10.00am	All day	Bachelor
Reality Bites: A VR Experience Inside the Human Body	<a href="#">Alumni Courtyard</a>	Activity	10.00am	All day	Bachelor
Maths and Statistics: Unlock the Secrets	<a href="#">Building 14 Level 6 Room 16</a>	Activity	10.00am	All day	Bachelor
Bioscience and Biotechnology Major	<a href="#">Building 12 Level 13 Room 2</a>	Presentation	10.40am	30 mins	Bachelor
Chemistry Major	<a href="#">Building 12 Level 13 Room 2</a>	Presentation	11.20am	30 mins	Bachelor
Maths and Statistics Majors	<a href="#">Building 12 Level 13 Room 2</a>	Presentation	1.20pm	30 mins	Bachelor
Physics Major	<a href="#">Building 12 Level 13 Room 2</a>	Presentation	12.00pm	30 mins	Bachelor
Space Science	<a href="#">Building 12 Level 13 Room 2</a>	Presentation	12.40pm	30 mins	Bachelor
Surveying	<a href="#">Building 12 Level 12 Room 2</a>	Presentation	1.50pm	30 mins	Bachelor
Surveying and Geospatial Science	<a href="#">Alumni Courtyard</a>	Info point	10.00am	All day	Bachelor
Surveying: Measuring our World with Lasers and Robots	<a href="#">Alumni Courtyard</a>	Display	10.00am	All day	Bachelor
Women in STEM	<a href="#">Building 10 Level 4 Room 51 (near Student Connect)</a>	Info point	10.00am	All day	All levels of study
	<a href="#">Building 80 Level 10 Room 17</a>	Presentation	11.30am, 12.30pm	30 mins	All levels of study

### Visit the Computing and Science Immersive Hub

Explore the latest advancements in technology and science. Engage with interactive experiences, inspiring talks, and innovative demonstrations. Unleash your curiosity and be amazed in the Alumni Courtyard.

For more information visit  
[rmit.edu.au/socialcommunity](http://rmit.edu.au/socialcommunity)

## Social and Community

	Location	Activities	Time	Duration	Study level
Alcohol and Other Drugs	<a href="#">Building 8 Level 2 Kaleide Theatre Foyer</a>	Info point	10.00am	All day	Certificate
Community Services	<a href="#">Building 8 Level 2 Kaleide Theatre Foyer</a>	Info point	10.00am	All day	Certificate/Diploma
	<a href="#">Building 8 Level 2 Kaleide Theatre</a>	Presentation	12.05pm	20 mins	Certificate/Diploma
Course in Recognising and Responding to Sexual Violence	<a href="#">Building 8 Level 2 Kaleide Theatre Foyer</a>	Info point	10.00am	All day	
Disability Support	<a href="#">Building 51 Level 2 Room 5</a>	Info point	10.00am	All day	Certificate

**KEY:****Info point** Drop-in, drop-out areas where you can speak to us about your course at any time.**Presentation** Hear from our academics on hot topics in your study area or get an overview of your course.**Tour** Join a study area tour to discover the facilities your course will be taught in.**Display** Exhibits and demonstrations relevant to your course or study area.**Activity** Practical tasks and experiences suitable for all skill levels.**Workshop** Informative and interactive discussions with current students and academics.

For more information visit  
[rmit.edu.au/socialcommunity](http://rmit.edu.au/socialcommunity)

## Social and Community (continued)

	Location	Activities	Time	Duration	Study level
Individual Support	<a href="#">Building 51 Level 2 Room 5</a>	Info point	10.00am	All day	Certificate
	<a href="#">Building 80 Level 3 Room 4</a>	Info point	10.00am	All day	Bachelor
International Studies	<a href="#">Building 80 Level 3 Room 15</a>	Presentation	10.00am, 11.15am, 12.30pm, 2.00pm	45 mins	Bachelor
International Studies – Languages	<a href="#">Building 80 Level 3 Room 3</a>	Info point	10.00am	All day	Bachelor
Learn a Language – Chinese	<a href="#">Building 80 Level 3 Room 1</a>	Activity	11.00am	15 mins	N/A
Learn a Language – French	<a href="#">Building 80 Level 3 Room 1</a>	Activity	12.00pm	15 mins	N/A
Learn a Language – Japanese	<a href="#">Building 80 Level 3 Room 1</a>	Activity	1.00pm	15 mins	N/A
Learn a Language – Spanish	<a href="#">Building 80 Level 3 Room 1</a>	Activity	2.00pm	15 mins	N/A
Mental Health	<a href="#">Building 8 Level 2 Kaleide Theatre Foyer</a>	Info point	10.00am	All day	Certificate
	<a href="#">Building 8 Level 2 Kaleide Theatre Foyer</a>	Info point	10.00am	All day	Bachelor
Social Science (Psychology)	<a href="#">Building 8 Level 2 Kaleide Theatre</a>	Presentation	10.00am, 11.05am, 1.10pm, 2.10pm, 3.15pm	20 mins	Bachelor
Social Work	<a href="#">Building 8 Level 2 Kaleide Theatre Foyer</a>	Info point	10.00am	All day	Bachelor
	<a href="#">Building 8 Level 2 Kaleide Theatre</a>	Presentation	10.30am, 12.35pm, 2.40pm	25 mins	Bachelor
Social Work (Honours)/ Social Science (Psychology)	<a href="#">Building 8 Level 2 Kaleide Theatre Foyer</a>	Info point	10.00am	All day	Bachelor/Honours
	<a href="#">Building 8 Level 2 Kaleide Theatre</a>	Presentation	10.30am, 12.35pm, 2.40pm	25 mins	Bachelor/Honours
Translating and Interpreting	<a href="#">Building 80 Level 3 Room 4</a>	Info point	10.00am	All day	Certificate/Diploma/ Advanced Diploma
Youth Work	<a href="#">Building 8 Level 2 Kaleide Theatre Foyer</a>	Info point	10.00am	All day	Certificate/Diploma/ Bachelor
	<a href="#">Building 8 Level 2 Kaleide Theatre</a>	Presentation	11.35am, 1.40pm	20 mins	Certificate/Diploma/ Bachelor

**KEY:****Info point** Drop-in, drop-out areas where you can speak to us about your course at any time.**Presentation** Hear from our academics on hot topics in your study area or get an overview of your course.**Tour** Join a study area tour to discover the facilities your course will be taught in.**Display** Exhibits and demonstrations relevant to your course or study area.**Activity** Practical tasks and experiences suitable for all skill levels.**Workshop** Informative and interactive discussions with current students and academics.





# Brunswick campus

Sunday 11 August, 10am-3pm

## General information

	Location	Activities	Time	Duration	Study level
Introduction to RMIT and Early Offer	<a href="#">Building 514</a> <a href="#">Level 2 Room 1</a>	<b>Presentation</b>	12.00pm	60 mins	All levels of study

### Explore careers in fashion and textiles

Immerse yourself in an interactive journey through fashion and textile design, technology and enterprise. Witness live photoshoots, see behind the scenes, and engage with students as they test their work and discuss the creative process. Discover the exciting opportunities in fashion and textiles.

Refer to page 44 for further information.

### Visit the Brunswick campus

Bus departing City campus travelling to Brunswick campus from Russell Street.

10.30am, 11.00am, 11.30am, 12.00pm, 1.00pm, 1.30pm, 2.00pm, 2.30pm, 3.00pm, 3.30pm

Bus departing Brunswick campus travelling to City campus from behind Building 514.

10.00am, 10.30am, 11.00am, 11.30am, 12.30pm, 1.00pm, 1.30pm, 2.00pm, 2.30pm, 3.00pm, 3.30pm

#### KEY:

**Info point** Drop-in, drop-out areas where you can speak to us about your course at any time.

**Presentation** Hear from our academics on hot topics in your study area or get an overview of your course.

**Tour** Join a study area tour to discover the facilities your course will be taught in!

**Display** Exhibits and demonstrations relevant to your course or study area.

**Activity** Practical tasks and experiences suitable for all skill levels.

**Workshop** Informative and interactive discussions with current students and academics.

# Brunswick campus

Sunday 11 August

- Building for Open Day
- Other Building
- 123 Building Number
- Road
- Railway
- Parklands

## Transport and Services

-  Food and Beverage
-  First Aid
-  Security
-  Parking
-  Food Trucks
-  Bus Stop—free bus to City campus
-  Ramp
-  Emergency Assembly Area

## General Info Points

-  Welcome Tent
-  Student Clubs
-  Entertainment Precinct
-  Student Fashion in Focus
-  Design and Fashion Precinct
-  General Information
-  Industry and Global Experiences
-  Prize Hub
-  514 Vocational Fashion and Textiles
-  516 Auditorium and Fashion Hub

\* Showcasing the exciting opportunities of careers in Fashion & Textiles, the Live Experience will immerse you in an interactive journey through fashion and textile design, technology, and enterprise. See the behind the scenes of students working on live photoshoots, testing their work and discussing the creative process.



To find out the times and locations of events happening around campus, scan the QR code to view the full schedule.





P

To Jewell train station

511

512

Student Fashion in Focus

513

514

Bus depart for City campus

P

## Design



For more information visit  
[rmit.edu.au/design](http://rmit.edu.au/design)

	Location	Activities	Time	Duration	Study level
Graphic Design	<a href="#">Building 515 Level 2 Room 12</a>	<b>Info point</b> Display	10.00am	All day	Certificate/Diploma Associate Degree
	<a href="#">Building 515 Level 3 Room 6</a>	<b>Presentation</b>	11.30am, 1.30pm	30 mins	Certificate/Diploma Associate Degree
	<a href="#">Building 515 Level 2 Rooms 10-11</a>	Display	11.00am	120 mins	Certificate/Diploma Associate Degree
Product Design	<a href="#">Building 515 Level 1 Room 8, 10-12</a>	<b>Info point</b> Display	10.00am	All day	Diploma

Click on building location to open Google Maps

## Fashion



For more information visit  
[rmit.edu.au/fashion](http://rmit.edu.au/fashion)

	Location	Activities	Time	Duration	Study level
Custom Made Footwear	<a href="#">Building 514 Level 1 Room 1</a>	<b>Info point</b>	10.00am	All day	Certificate/Diploma
	<a href="#">Building 513 Level 2 Room 4</a>	Activity	12.30pm	30 mins	Certificate/Diploma
Custom Made Footwear and Textile Design	<a href="#">Building 514 Level 2 Room 1</a>	<b>Presentation</b>	11.30am	30 mins	Certificate
Fashion (Business and Retail and Design and Technology)	<a href="#">Building 514 Level 1 Room 1</a>	<b>Info point</b>	10.00am	All day	Associate Degree
Fashion and Textiles Live Experience	<a href="#">Building 516 Level 2 Room 1</a>	Activity	10.00am	All day	All levels of study
Fashion and Textiles Design, Technology and Enterprise	<a href="#">Building 516 Level 2 Room 5</a>	<b>Presentation</b>	11.15am	30 mins	Bachelor
Fashion and Textiles Interactive Experience	<a href="#">Building 514 Level 1 Room 1</a>	Activity	10.00am	All day	All levels of study
Fashion and Textiles Sustainable Innovation	<a href="#">Building 516 Level 1 Room 10</a>	<b>Info point</b>	10.00am	All day	Bachelor
	<a href="#">Building 516 Level 2 Room 5</a>	<b>Presentation</b>	1.15pm	30 mins	Bachelor
Fashion <ul style="list-style-type: none"> <li>■ Business and Retail</li> <li>■ Design and Technology</li> <li>■ Fashion Styling</li> </ul>	<a href="#">Building 514 Level 1 Room 1</a>	<b>Info point</b>	10.00am	All day	Associate Degree
	<a href="#">Building 514 Level 2 Room 1</a>	<b>Presentation</b>	10.30am, 2.30pm	30 mins	Associate Degree/ Diploma
	<a href="#">Building 514 Level 2 Room 1</a>	<b>Presentation</b>	1.00pm	45 mins	Certificate/Diploma Associate Degree
Fashion degree film	<a href="#">Building 516 Level 2 Room 5</a>	<b>Presentation</b>	12.00pm	30 mins	Bachelor/Honours/ Master

### KEY:

**Info point** Drop-in, drop-out areas where you can speak to us about your course at any time.

**Presentation** Hear from our academics on hot topics in your study area or get an overview of your course.

**Tour** Join a study area tour to discover the facilities your course will be taught in.

**Display** Exhibits and demonstrations relevant to your course or study area.

**Activity** Practical tasks and experiences suitable for all skill levels.

**Workshop** Informative and interactive discussions with current students and academics.



For more information visit  
[rmit.edu.au/fashion](http://rmit.edu.au/fashion)

## Fashion (continued)

	Location	Activities	Time	Duration	Study level
Fashion Design	<a href="#">Building 516</a> <a href="#">Level 1 Rooms 4 and 5</a>	Info point	10.00am	All day	Bachelor
	<a href="#">Building 516</a> <a href="#">Level 2 Room 5</a>	Presentation	10.30am, 2.00pm	30 mins	Bachelor
Fashion Design – Roaming	<a href="#">Building 516</a> <a href="#">Level 1 Room 4</a>	Activity	10.00am	All day	Bachelor/Honours
Fashion Design Alumni Work	<a href="#">Building 516</a> <a href="#">Levels 1 and 2</a>	Display	10.00am	All day	N/A
Fashion Enterprise	<a href="#">Building 516</a> <a href="#">Level 1 Room 10</a>	Info point	10.00am	All day	Bachelor
	<a href="#">Building 516</a> <a href="#">Level 2 Room 5</a>	Presentation	12.30pm	30 mins	Bachelor
Fashion, Textiles and Footwear	<a href="#">Building 513</a> <a href="#">Level 1 Room 1</a>	Tour	10.00am, 11.00am, 12.00pm, 2.00pm	30 mins	Certificate/Diploma Associate Degree
Textile Design	<a href="#">Building 516</a> <a href="#">Level 1 Room 9</a>	Info point	10.00am	All day	Bachelor
Textile Design and Technology	<a href="#">Building 514</a> <a href="#">Level 1 Room 1</a>	Info point	10.00am	All day	Certificate/Diploma
	<a href="#">Building 513</a> <a href="#">Level 1 Room 2</a>	Activity	10.30am, 2.00pm	30 mins	N/A

Click on building location to open Google Maps

**KEY:**

**Info point** Drop-in, drop-out areas where you can speak to us about your course at any time.

**Presentation** Hear from our academics on hot topics in your study area or get an overview of your course.

**Tour** Join a study area tour to discover the facilities your course will be taught in.

**Display** Exhibits and demonstrations relevant to your course or study area.

**Activity** Practical tasks and experiences suitable for all skill levels.

**Workshop** Informative and interactive discussions with current students and academics.









# **Campus free wifi**

Connect to RMIT wireless network

## **Bundoora**

---

---

Network: RMIT-Guest

Code: 215378

## **Brunswick**

---

---

Network: RMIT-Guest

Code: 514971

## **City**

---

---

Network: RMIT-Guest

Code: 995149

# Register your attendance to claim your freebie!



Let us know you attended Open Day  
and visit us at a Prize Hub to claim  
your instant prize.

We have Prize Hubs located around our campuses, to claim your freebie:

1. Register your attendance by scanning the QR Code above.
2. Show your confirmation of registration to one of the Prize Hub crew.
3. Claim your freebie.

To find a Prize Hub, visit our campus maps

\*Terms and conditions apply

## Contact us

330 Swanston Street (cnr La Trobe Street)  
Melbourne VIC 3000  
+61 3 9925 2260

## Connect with RMIT

